

This document contains:

- The Event Covid-19 risk assessment and risk mitigation plan in accordance with the [FEI Policy for Enhanced Competition Safety during the Covid-19 Pandemic](#)
- The Event Approved Schedule

Given the current covid-19 situation, please note that the FEI's approval of a Schedule should not be taken as an absolute guarantee that the Event will definitely go ahead. The decision whether the Event can take place must be made by the OC and NF in close consultation with the applicable domestic government and public health authorities. It is the responsibility of each Participant to check the status of the Event prior to planning his/her travel to the Event.

Risk assessment for COVID-19

The questions below will enable OCs to review the additional considerations specific to sports, and thus inform their risk assessment of COVID-19 associated with their Event. This will help OCs understand and manage any additional risk from COVID-19.

The risk assessment should be reviewed and reassessed regularly during the planning phase and updated immediately prior to the transition to the operational phase, especially in light of the rapidly evolving nature of the outbreak. Reference should be made to the latest technical guidance and situation reports on the WHO website.

The risk assessment for COVID-19 associated with the Event must be coordinated and integrated with the host country's national risk assessment for COVID-19. The person completing the questionnaire should include input from the local public health authorities, consult WHO's latest technical guidance and ensure that there is an up-to-date evaluation of the epidemiological situation.

Please answer Yes (1) or No (0) to the following questions to determine a risk assessment score that incorporates factors specific to sporting events

| Additional risk of COVID-19 to the sporting event | Yes (1)/No (0) | Score |
|---|----------------|----------|
| Will the event be held in a country that has documented active local transmission of COVID-19 (community spread)? | 1 | 1 |
| Will the event be held in a single venue or multiple venues/cities/countries? (single venue = 0; multiple venues = 1) | 0 | 0 |
| Will the event include international participants (athletes and spectators) from countries that have documented active local transmission of COVID-19 (community spread)? (NB: if the Events does not involve spectators, please clarify this in the comments to the questions in relation to spectators in the "Mitigation Checklist" sheet) | 1 | 1 |
| Will the event include a significant number of participants (athletes or spectators) at higher risk of severe COVID-19 disease (e.g., people over 65 years of age or people with underlying health conditions)? | 0 | 0 |
| Will the event include sports that are considered at higher risk of spread for COVID-19 (eg, contact sports)? | 0 | 0 |
| Will the event be held indoors? (Yes = 1; No = 0) | 1 | 1 |
| Total COVID-19 risk score | | 3 |

Mitigation checklist for COVID-19

Mitigation measures assess the current effort and planning to reduce the risk of spread of COVID-19 disease for the event. As mitigation measures can reduce the overall risk of the sporting event contributing to the spread of COVID-19, they should be taken into account after the risk assessment has occurred to gain a clearer understanding of the overall risk of transmission and further spread of COVID-19, should the event be held. Together with the risk assessment score, the mitigation measure will contribute to the decision matrix and influence the assessment of the overall risk of transmission and further spread of COVID-19 in relation to the event.

| Topic | Key consideration | Score Yes/Completed (2), Maybe/In progress (1), No/Not considered (0) | Weighting | Total score | Comments |
|---|--|--|-----------|----------------|---|
| Understanding of the overview of the current COVID-19 situation by the OC | Have the relevant OC and responsible staff been informed about the latest available guidance on the COVID-19 outbreak (official web resources available from WHO, CDC, ECDC, UN, local public health authorities)? And are the OC and staff concerned committed to following the available guidance? | 2 | 1 | 2 | (https://www.who.int/publicationsdetail/key-planning-recommendations-for-mass-gatherings-in-the-context-of-the-current-covid-19-outbreak) |
| | Is the OC aware of global and local daily situation reports as provided by WHO or local public health authorities? | 2 | 1 | 2 | |
| | Do the OC and responsible staff understand the risks and transmission routes of COVID-19, the steps that Event attendees can take to limit spread, the recognized best practices (including respiratory etiquette, hand hygiene, physical distancing, etc.), and the travel restrictions adopted by different countries that may affect the Event? | 2 | 1 | 2 | |
| Event emergency preparedness and response plans | Has a contingency medical response plan for COVID-19 been developed for the Event? | 2 | 3 | 6 | |
| | Does the contingency medical response plan include information about how attendees should interact with the host country healthcare system (e.g. hotline/helpline telephone number, medical teams and first-aid points for the Event, local health care system)? | 2 | 3 | 6 | |
| | Is there an Emergency COVID-19 Outbreak Response Coordinator/Team in the OC or other structure structure for the Event with defined roles and responsibilities, coordinating the health preparedness and response planning for the outbreak? | 2 | 2 | 4 | |
| | Has the host country or OC requested support from WHO and/or local public health authorities ? | 2 | 3 | 6 | |
| | Has the OC acquired the following supplies to help reduce the risk of transmission of COVID-19? | | | | |
| | Personal protective equipment (e.g. masks, gloves, gowns) for onsite medical personnel | 2 | 3 | 6 | |
| | Hand sanitizer and alcohol rubs/gels, tissues, frequently replaced soap canisters and closed bins for safe disposal of hygienic materials (e.g. tissues, towels, sanitary products) in washrooms and changing rooms | 2 | 3 | 6 | |

| | | | | |
|---|---|---|---|--|
| Hand sanitizers and alcohol rubs for all entrances and throughout the venue | 2 | 3 | 6 | |
| If a person feels unwell/ shows symptoms of an acute respiratory infection during the Event: | | | | |
| Is there a procedure for athletes or spectators to clearly identify whom to contact and how to do so if they or other Event participants feel unwell? | 2 | 3 | 6 | |
| Is there a protocol on whom the OC should contact in the host country to report suspected cases and request testing and epidemiological investigations? | 2 | 3 | 6 | |
| Are first-aid services or other medical services in-place and equipped to support patients with respiratory symptoms? | 2 | 2 | 4 | |
| Are there isolation rooms or mobile isolation units available onsite? | 2 | 2 | 4 | |
| Are there any designated medical facilities that manage patients with COVID-19 infection in the host country? | 2 | 2 | 4 | |
| Are there transportation services with trained medical professionals available to transport critically ill patients with severe acute respiratory infections to a hospital or to evacuate them from the host country, if necessary? | 2 | 2 | 4 | |
| Has a cleaning schedule been developed to ensure the venue is clean and hygienic – wiping surfaces and any equipment regularly with disinfectant is strongly recommended (before, during and after the event and between each round of competition)? | 2 | 3 | 6 | |
| Are there established screening measures , including temperature checks in place for participants at the point of entry, venues, routes and on-site medical facilities (first-aid points)? (Please specify in Comments what these screening measures include) | 2 | 3 | 6 | |
| Is the host country conducting COVID-19 laboratory diagnostic tests ? (If Yes, please specify in comments the type of COVID-19 diagnostic test used) | 2 | 3 | 6 | |
| Does the host country have a national public health emergency preparedness and response plan that can address severe respiratory diseases, including COVID-19? | 2 | 2 | 4 | |
| Is there a preliminary agreement by the host country to provide care for any COVID-19 cases connected with the Event? | 2 | 3 | 6 | |
| If the Event is for a duration of 14 days or longer, does the medical response plan for the event include resources and protocols for managing all public health interventions that would be necessary and supporting the national public health authorities if participants are infected and become unwell at the Event? (If the event is for less than 14 days, please score 0) | 2 | 3 | 6 | |
| If the Event is for less than 14 days, does the medical response plan include protocols for OCs to notify all participants of possible exposure to COVID-19 if the OCs are made aware of any suspected or confirmed cases that attended the Event? (If the event is for 14 days or longer, please score 0) | 0 | 3 | 0 | |
| Is there an established mechanism for collaboration and coordination between the health and security sectors , which is considered as crucial? | 2 | 2 | 4 | |

| | | | | | |
|---|--|---|---|---|--|
| Stakeholder and partner coordination | Are there agreed, clear and easily understood processes in place for reporting to external multi-sectoral stakeholders (including surveillance authorities, WHO, CDC, ECDC, etc.) and disseminating risk communication messages (Media)? | 0 | 2 | 0 | |
| | | | | | |
| Command and control | Is there a decision-making authority/body and an agreed procedure to modify, restrict, postpone or cancel the Event related to the evolving COVID-19 outbreak? | 2 | 3 | 6 | |
| | Are there arrangements to activate a strategic health operations centre if there are suspected COVID-19 cases in connection with the Event? | 0 | 2 | 0 | |
| | Have the OC and staff undergone training and exercises on personal safety procedures and emergency mitigation measures (including those specifically listed in this checklist)? | 2 | 3 | 6 | |
| Risk communication | Is there a risk communication strategy for the Event in regard to COVID-19? | 2 | 3 | 6 | |
| | Is there a designated person(s) to lead media activities and tasked with managing all external communications with national and international government officials, the general public, and the media? (If yes, please identify the spokesperson in comments) | 2 | 2 | 4 | |
| | Has there been monitoring of national and international media and social media established for rumours to be able to counter them early? (Please explain in the comments what protocols are in place for counter messaging) | 2 | 2 | 4 | |
| | Has coordination been set up with major official media channels and social media sites such as Twitter, Facebook and Instagram so that messaging can be coordinated with, and assisted by, the platforms to provide targeted messaging from OCs (including messaging to counter fake news and rumours, and proactive messaging about the status of the sporting event, including changes)? | 2 | 2 | 4 | |
| Public health awareness of COVID-19 before and during the event | Has public health advice on clinical features of COVID-19, preventive measures, especially respiratory etiquette, hand hygiene practices, and physical distancing, been shared with all staff involved in the Event, athletes, the public, and personnel of all relevant stakeholders? | 2 | 3 | 6 | |
| | Has information on the at-risk populations been provided to all athletes, the public and others so they may make an informed decision on their attendance based on their personal risks? | 2 | 3 | 6 | |
| | Has public advice included information on the meaning of the following measures: quarantine, self-isolation and self-monitoring ? | 2 | 2 | 4 | |
| Surge capacity | Are there any surge arrangements in place in the event of a public health emergency during the Event - (i.e. suspected and confirmed cases of COVID-19? | | | | |
| | Do these surge arrangements include funding for mitigation measures? | 2 | 3 | 6 | |
| | Do these surge arrangements include stockpiles of equipment (e.g. personal protective equipment, etc.) | 2 | 3 | 6 | |
| | Do these surge arrangements include training of extra staff? | 2 | 2 | 4 | |
| | Do these surge arrangements include volunteers? | 2 | 2 | 4 | |
| | Will there be daily health checks of athletes/competitors? | 2 | 2 | 4 | |
| | Will the athletes be separated from other groups , such as officials, support staff and spectators, to limit transmission? | 2 | 2 | 4 | |

| | | | | | |
|------------------------------|---|---|---|---|--|
| Specific mitigation measures | Are there measures in place to limit the sharing of equipment, water bottles, towels, etc. ? | 0 | 3 | 0 | |
| | Will athletes be given closed containers to allow for the safe disposal or storing of all hygienic materials (e.g. tissues, towels, etc.)? | 0 | 3 | 0 | |
| | Will the Event have designated seating for all spectators? | 2 | 3 | 6 | |
| | Does the designated seating provided allow for physical distancing between spectators (minimum of 1 metre)? | 2 | 2 | 4 | |
| | Have pre-travel health checks been performed on all athletes to ensure underlying co-morbidities, medications, allergies, etc. are documented? | 0 | 2 | 0 | |

| | |
|-----------------------------------|-----------|
| Sum of mitigation measures | 196 |
| Total mitigation score (%) | 89 |

196

Event overall risk score

The decision matrix takes the risk score and the mitigation score to provide a colour determination. This colour determination identifies the total risk of transmission and further spread of COVID-19 in relation to the Event. The "Colour Determination" key below the decision matrix describes the total risk for each colour.

| | |
|---|---|
| Total COVID-19 risk score (from "Risk Assessment" Tab) | 3 |
|---|---|

| | |
|--|----|
| Total mitigation score (from "Mitigation Checklist" Tab) | 89 |
|--|----|

Risk Vs. Mitigation Matrix

| Total Risk Assessment Score | Very Prepared to Mitigate COVID-19 Impacts (76-100) | Somewhat Prepared to Mitigate COVID-19 Impacts (51-75) | Somewhat Unprepared to Mitigate COVID-19 Impacts (26-50) | Very Unprepared to Mitigate COVID-19 Impacts (0-25) |
|-----------------------------------|---|--|--|---|
| 0 - Negligible | Very low | Very low | Very low | Very low |
| 1 - Very Low Risk | Very low | Very low | Low | Low |
| 2 - Low Risk | Low | Low | Low | Moderate |
| 3 - Moderate Risk (low-moderate) | Low | Moderate | Moderate | Moderate |
| 4 - Moderate Risk (high-moderate) | Moderate | Moderate | High | Very High |
| 5 - High Risk | High | High | Very High | Very High |
| 6 - Very High Risk | Very High | Very High | Very High | Very High |

| KEY FOR COLOUR DETERMINATION OF OVERALL RISK | |
|--|--|
| VERY LOW | Overall risk of transmission and further spread of COVID-19 in relation to the Event is considered <u>very low</u> . |
| LOW | Overall risk of transmission and further spread of COVID-19 in relation to the Event is considered <u>low</u> . Recommend checking whether mitigation measures can be strengthened. |
| MODERATE | Overall risk of transmission and further spread of COVID-19 in relation to the Event is considered <u>moderate</u> . Recommend <u>significant</u> efforts to improve mitigation measures or reduce risk of transmission (decrease risk assessment score). |
| HIGH | Overall risk of transmission and further spread of COVID-19 in relation to the Event is considered <u>high</u> . Recommend <u>significant</u> efforts to improve <u>both</u> mitigation measures and reduce risk of transmission (decrease risk assessment score). |
| VERY HIGH | Overall risk of transmission and further spread of COVID-19 in relation to the Event is considered <u>very high</u> . |



RISK MITIGATION PLAN

CSIO5* Sopot
17-20 06 2021





Introduction

- Due to Covid-19 pandemic, we kindly ask you to familiarize with this document to minimise risk of infection.
- Despite following these Guidelines that are to reduce to minimum risk of infection with Covid-19 during the competition this risk is not eliminated.
- Every Participant of the event is obliged to familiarize with these Guidelines. Negligence of acknowledgment of the Guidelines doesn't relive from the duty of following the rules.
- All the Participants of the event (excluding Organiser's employees) are taking part voluntarily and on their own responsibility.
- All Participants are required to comply with the rules of social coexistence and conduct in accordance with applicable law and regulation of these Guidelines and other regulations in force in the competition established by the Organiser.
- All who decide to take part in the event (in any role) and are allowed to participate in the event by Organiser during the pandemic are doing so at their own risk.
- The Organising Committee doesn't take any responsibility for infection with Covid-19 of anyone taking part in the event.





Participant of the event

A Participant of the event is a person whose presence on the showground is essential for the sports competition, in particular:

- Competitor
- Supporting personnel- trainer, groom, horse owner and responsible person of a minor athlete
- Person responsible for horse transport
- Official
- Event staff
- Security staff
- TV operators
- Media representatives
- Spectators



Restrictions of participation

The following restriction of participation in the event must be followed:

- The event takes place with **25% OF POSSIBLE spectators** - in accordance with current regulations in Poland.
- Only healthy individuals with temperature less than 37.5 °C from the accredited list will be given access to the showground
- Press Office will work only as remotely (online). The number of Press Office Staff will be limited.
- The Organiser is going to issue limited number of PRESS and PHOTO accreditations - one per editorial office /except Official photographers of Organiser and FEI/..





The procedure of entering the showground

- All the Participants of the event are entering the showground using only the entry or gates specified by Organiser. There's a clearly marked on the map control point located at the gate.

Wednesday 10:00 – 21:00 (no earlier arrival available)

- At the control point, Security Staff checks and verify all the participants from the list provided by National Federation, does a health interview and measures the temperature.
- A measurement of the temperature is an obligatory procedure and it's anonymous. 4. If temperature is greater than 37.5 degrees C the person cannot enter the venue
- Refusing to follow the procedure of taking the temperature results denning the access to the showground.
- During the control procedure, Security Staff has a right to: a) Ask for an ID document b) Ask to leave the vehicle
- Each Participant given the access the showground will be marked with a wristband.
- In case of any health issues reported by any Participant Security staff will not give an access to the showground and will inform the Organiser and Medical Staff.
- Each Participant is responsible for going through the control point and the procedure of entering the showground to get the wristband for the day.
- Entering the showground without the wristband will result with an admin charge 100 EUR and in case of repeated violation of the rules expelling from the showground.





Security on the showground

1. Each of the Participants must :
 - a) Cover, mask, shield or protective hat the mouth and nose unless there's a 1,5 m distance from other Participants in the same space; this rule excludes an Athlete sitting on the horse;
 - b) Systematic sterilising hands at the stations located in toilets area, show office, competition zone, stables.
2. The Organiser will assign a Steward who with cooperation with the Organiser will coordinate and supervise the security system especially the logistic of Participants, access to sanitizers, covering mouth and nose by Participants
3. All the rooms used during the event will be disinfected after each day of the event.

The most common symptoms of Covid-19 are fever, dry cough, and tiredness. Other symptoms that are less common and may affect some patients include aches and pains, nasal congestion, headache, conjunctivitis, sore throat, diarrhoea, loss of taste or smell or a rash on skin or discoloration of fingers or toes. These symptoms are usually mild and begin gradually (Source: WHO website: <https://www.who.int/emergencies/diseases/novelcoronavirus-2019/question-and-answers-hub/q-a-detail/q-a-coronaviruses>) and the Participants must immediately: 1. Go to the assigned by the Organiser isolation space. 2. Call the Organizer on 0048602390230 The Organiser will contact with the Regional Sanitary and Epidemiological Station, competent for the showground of the event, or the 24-hour NFZ hotline 800-190-590.





Limitations and guidelines for specific groups of Participants

1. ATHLETES:

Athletes can access Car Parking Zone, Stables, Show Office and Competition Zone where they need to keep 2 m of social distance.

Minor Athletes can be accompanied by his/her representative (one per Athlete).

Athletes are not allowed in the Ground Jury box.

All the issues are solved remotely. All official protests are managed in the Show Office as per PZJ and FEI rules. • all Show Jumping classes course walking takes place with keeping 2m social distance rule.

2. TRAINERS

Trainers can access Car Parking Zone, Stables, Show Office and Competition Zone where they need to keep 2 m of social distance.

Before jumping test the trainer is allowed to enter the warm up area only when the rider is jumping, 15 min before the test.





Limitations and guidelines for specific groups of Participants

3. GROOMS AND SUPPORTING TEAM

Grooms can access Car Parking Zone, Stables and Competition zone outside the warm up area and competition area where they need to keep 2 m of social distance.

In case the rider is not accompanied by the trainer, the groom is allowed to enter the warm up area only when the rider is jumping, 15 min before the start.

Supporting Team can access Car Park zone, Stables and Competition where they need to keep 2 m of social distance.

1. OFFICIALS • Officials i. e. judges, scribes, Ground Jury assistants while being indoors i.e. GJ box have Personal Protective Equipment. • Only Officials and essential staff responsible for running the test are allowed in GJ box area. • The distance between each working post must be 1.5m or post have to be divided with a screen or everyone has to have Personal Protective Equipment.
2. CAR PARK ZONE • Only Participants of the Event have access to Car Park Zone. • A distance of 1,5 m between vehicles have to be kept. • All Participants in the Car Park Zone has to keep 1,5 m distance • Any gathering of more than 10 persons are strictly forbidden in Car Park Zone.





Limitations in the Show Office

1. The distance between each working post must be 1.5m or post have to be divided with a screen or everyone has to wear a head shield.
2. The number of people allowed in the Show Office is determined on the square meter space- the coefficient should be 10m² per 1 person under condition there's one person being served at the post.
3. Access to Show Office is only limited to Staff, Officials, Athletes and Supporting Team.





Limitations for media

1. Press Office will work only as remotely (online).
2. The number of Press Office Staff will be limited
3. The Organiser is going to issue limited number of PRESS and PHOTO accreditations one per editorial office /except Official photographers of Organiser and FEI/.
4. Access to the showground is only given to: • Press Office Staff- press staff, social media staff, photo staff, video staff • Media Partners representative- one per editorial • FEI accredited media- FEI TV, photographer • TV coverage staff • Online coverage staff
5. The Organiser will not provide for accredited media the Press Office or the Media Room All Media representatives are to fill in the health check form and follow the procedure of temperature measurement every day. Also, they must inform the Organiser about the most common symptoms of Covid 19. The most common symptoms of Covid-19 are fever, dry cough, and tiredness. Other symptoms that are less common and may affect some patients include aches and pains, nasal congestion, headache, conjunctivitis, sore throat, diarrhoea, loss of taste or smell or a rash on skin or discoloration of fingers or toes. These symptoms are usually mild and begin gradually. (Source: WHO website: <https://www.who.int/emergencies/diseases/novel-coronavirus-2019/question-and-answers-hub/q-a-detail/q-acoronaviruses>)





Limitations for Sponsors

1. The number of Sponsor representatives who will have access to the showground and to the specific zones will be limited.
2. Sponsor representatives are only allowed to access Competition zone All Sponsor representatives are to fill in the health check form and follow the procedure of temperature measurement every day. Also, they must inform the Organiser about the most common symptoms of Covid 19. The most common symptoms of Covid-19 are fever, dry cough, and tiredness. Other symptoms that are less common and may affect some patients include aches and pains, nasal congestion, headache, conjunctivitis, sore throat, diarrhoea, loss of taste or smell or a rash on skin or discoloration of fingers or toes. These symptoms are usually mild and begin gradually. (Source: WHO website: <https://www.who.int/emergencies/diseases/novel-coronavirus-2019/question-and-answers-hub/q-a-detail/q-acoronaviruses>)





Limitations for trade stands

1. Trade stands are limited so that they will use 50% of average CSIO Sopot occupied exhibition space.
2. At the entrance and at the till point there should be hand sanitizer available All the staff of trade stands is to fill in the health check form and follow the procedure of temperature measurement every day. Also, they must inform the Organiser about the most common symptoms of Covid 19. The most common symptoms of Covid19 are fever, dry cough, and tiredness. Other symptoms that are less common and may affect some patients include aches and pains, nasal congestion, headache, conjunctivitis, sore throat, diarrhoea, loss of taste or smell or a rash on skin or discoloration of fingers or toes. These symptoms are usually mild and begin gradually. (Source: WHO website: <https://www.who.int/emergencies/diseases/novel-coronavirus-2019/question-and-answers-hub/q-a-detail/q-acoronaviruses>).





Limitations for hospitality/ catering

1. 50% of average used tables will be accessible in the indoor catering space
2. 50% of average used seats will be accessible in the VIP Tent, with the 2m social distance
3. All the hospitality / catering staff is to fill in the health check form and follow the procedure of temperature measurement every day. Also, they must inform the Organiser about the most common symptoms of Covid 19. The most common symptoms of Covid-19 are fever, dry cough, and tiredness. Other symptoms that are less common and may affect some patients include aches and pains, nasal congestion, headache, conjunctivitis, sore throat, diarrhoea, loss of taste or smell or a rash on skin or discoloration of fingers or toes. These symptoms are usually mild and begin gradually. (Source: WHO website: <https://www.who.int/emergencies/diseases/novel-coronavirus-2019/question-and-answers-hub/q-a-detail/q-a-coronaviruses>).

Appendix

1. Were you diagnosed with SARS CoV-2 in the last 14 days?

☐ YES ☐ NO

2. Did you have contact with person diagnosed with SARS CoV-2 in the last 14 days?

☐ YES ☐ NO

3. Is your chills/pupil or anyone in your household in quarantine now?

☐ YES ☐ NO

4. Do you or anyone in your household have the most common symptoms of Covid-19?
The most common symptoms of Covid-19 are fever, dry cough and tiredness. Other symptoms that are less common and may affect some patients include aches and pains, headache, conjunctivitis, sore throat, loss of taste or smell or a rash on skin. These symptoms are usually mild and begin gradually.

☐ YES ☐ NO

5. Does anyone in your household hd any sympotoms mentioned above in the last 14 days?

☐ YES ☐ NO

NAME.....

COUNTRY.....

PHONE NUMBER.....



Appendix



Appendix



Appendix



HOW TO WASH YOUR HANDS

Clean hands protect against infection



www.ncheurope.com

[Contact us for more information](#)

[Discover our hand care line](#)

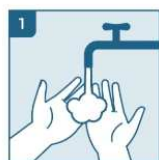

Wet hands

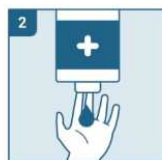

Use enough soap to cover all hand surfaces



Rub hands palm to palm



Right palm over left dorsum and left palm over right dorsum



Palm to palm with fingers interlaced

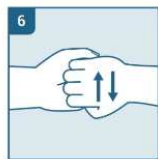

Backs of fingers to opposing palms with fingers interlocked

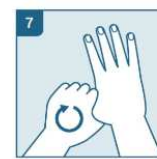

Rotational rubbing of right thumb clasped in left palm and vice versa



Rotational rubbing backwards and forwards with clasped fingers of right hand in left palm and vice versa



Rinse hands with water



Dry hands thoroughly with a single use towel



Use the towel to turn off the tap



Your hands are clean

Guideline by World Health Organization (WHO)

Photography copyright by: elenabel © / Shutterstock.com



Horse examination on Arrival ★ and Riders Accreditation ★



I. DENOMINATION OF THE EVENT

Venue: HIPODROM SOPOT

Date: 17-20 06 2021

NF: POL

Indoor: ☐

Outdoor: ☒

EVENT CATEGORIES:

| | | | | |
|--|----------------------------------|----------------------------------|-----------------------------------|-----------------------------------|
| CSIO5* <input checked="" type="checkbox"/> | CSIS*-W <input type="checkbox"/> | CSIS* <input type="checkbox"/> | CSIU25-A <input type="checkbox"/> | CSIU25-B <input type="checkbox"/> |
| CSIO4* <input type="checkbox"/> | CSI4*-W <input type="checkbox"/> | CSI4* <input type="checkbox"/> | CSIY-A <input type="checkbox"/> | CSIY-B <input type="checkbox"/> |
| CSIO3* <input type="checkbox"/> | CSI3*-W <input type="checkbox"/> | CSI3* <input type="checkbox"/> | CSIJ-A <input type="checkbox"/> | CSIJ-B <input type="checkbox"/> |
| CSIO2* <input type="checkbox"/> | CSI2*-W <input type="checkbox"/> | CSI2* <input type="checkbox"/> | CSIch-A <input type="checkbox"/> | CSIch-B <input type="checkbox"/> |
| CSIO1* <input type="checkbox"/> | CSI1*-W <input type="checkbox"/> | CSI1* <input type="checkbox"/> | CSIV-A <input type="checkbox"/> | CSIV-B <input type="checkbox"/> |
| CSIOY <input type="checkbox"/> | | CSIL1* <input type="checkbox"/> | CSIAm-A <input type="checkbox"/> | CSIAm-B <input type="checkbox"/> |
| CSIOJ <input type="checkbox"/> | | CSIYH2* <input type="checkbox"/> | CSIP <input type="checkbox"/> | |
| CSIOB <input type="checkbox"/> | | CSIYH1* <input type="checkbox"/> | | |
| CSIOCh <input type="checkbox"/> | | | | |

Championship ☐

Games ☐

II. GENERAL CONDITIONS

- FEI Statutes, 24th edition, effective 19 November 2019
- FEI General Regulations, 24th edition, 1st January 2020, updates effective 1st January 2021
- FEI Veterinary Regulations, 14th edition, 1 January 2018, updates effective 1st January 2021
- The Jumping Rules and its Annexes, 26th edition 1 January 2018, updates effective 1 January 2021
- <https://inside.fei.org/fei/regulations/jumping>
- CSI/CSIO Prize Money requirements 2020 – To be applied also for 2021
- <https://inside.fei.org/sites/default/files/Final%20CSIs-CSIOs%20-%202020.pdf>
- Longines Rankings – Groups Categories 2020 – To be applied also for 2021
- <https://inside.fei.org/sites/default/files/Final%20Longines%20Ranking%20Groups%20-%202020.pdf>
- Equine Anti-Doping and Controlled Medication Regulations (EADCMR), 3rd Edition, effective 1st January 2021
- FEI Anti-Doping Rules for Human Athletes (ADRHA), based upon the 2021 WADA Code, effective 1st January 2021
- The FEI Policy for Enhanced Competition Safety during the Covid-19 Pandemic, effective as of 1 July 2020 (updated 12 October 2020) and until further notice
- All subsequent published revisions/updates, the provisions of which will take precedence.

THE ANNEXE(S) IS/ARE PART OF THIS APPROVED AND SIGNED SCHEDULE AND MUST BE DISTRIBUTED TO ALL OFFICIALS AND NFs AND IS AVAILABLE TO OTHERS UPON REQUEST

Approved by the FEI, Lausanne, on 27/05/2021, updated on 28/05/2021, 14/06/2021



Marco Fusté
Jumping Director

NB: No modifications to the approved Schedule will be accepted less than two weeks prior to the event. Additionally, no change may be made to a Longines Ranking competition once the schedule has been approved. Prizes in kind, to be accepted as prize money to count for Longines Ranking competitions and total event prize money, must be easily convertible into cash (GRs Art. 127).

TABLE OF CONTENTS

| | | |
|--------------|--|-----------|
| I. | DENOMINATION OF THE EVENT | 1 |
| II. | GENERAL CONDITIONS | 1 |
| III. | THE FEI CODE OF CONDUCT FOR THE WELFARE OF THE HORSE | 3 |
| IV. | GENERAL INFORMATION | 4 |
| 1. | ORGANISER | 4 |
| 2. | ORGANISING COMMITTEE | 4 |
| 3. | EVENT DIRECTOR | 4 |
| 4. | STABLE MANAGER..... | 4 |
| 5. | ANNOUNCER | 4 |
| V. | OFFICIALS | 5 |
| VI. | INVITATIONS | 7 |
| 1. | GENERAL..... | 7 |
| VII. | ENTRIES | 10 |
| 1. | ENTRY DATES AND ENTRY FEES..... | 10 |
| 2. | OTHER FEES | 11 |
| 3. | NO-SHOWS/LATE WITHDRAWALS | 11 |
| VIII. | TIMETABLE..... | 13 |
| IX. | COMPETITION DETAIL..... | 15 |
| X. | FACILITIES OFFERED..... | 23 |
| 1. | ATHLETES | 23 |
| 2. | GROOMS..... | 23 |
| XI. | LOGISTICAL/ADMINISTRATIVE/TECHNICAL INFORMATION | 24 |
| 1. | DRAW | 24 |
| 2. | COMPETITION ARENA(S) | 24 |
| 3. | PRACTICE ARENA(S) | 24 |
| 4. | STABLES | 25 |
| 5. | SAFETY CUPS..... | 25 |
| 6. | TIMING DEVICE | 25 |
| 7. | SCORING/TIMING PROVIDER..... | 25 |
| 8. | OTHER TECHNOLOGY/SERVICE PROVIDER(S) | 26 |
| 9. | PRIZE GIVING CEREMONY | 26 |
| 10. | ADVERTISING ON ATHLETES AND HORSES..... | 26 |
| 11. | TICKETING..... | 26 |
| 12. | BETTING..... | 26 |
| 13. | TRANSPORT REIMBURSEMENT HORSES / PONIES | 26 |
| 14. | WELCOME..... | 27 |
| 15. | LOCAL TRANSPORTATION - ARRANGEMENTS FROM HOTEL TO SHOWGROUNDS | 27 |
| 16. | ENTRY RIGHT TO SHOWGROUNDS/ACCREDITED PERSONS..... | 27 |
| 17. | SUSTAINABILITY..... | 27 |
| XII. | VETERINARY MATTERS..... | 28 |
| 1. | CUSTOMS FORMALITIES | 28 |
| 2. | HEALTH REQUIREMENTS | 28 |
| 3. | NATIONAL REQUIREMENTS | 28 |
| 4. | PONIES..... | 28 |
| 5. | INJURY SURVEILLANCE..... | 28 |
| 6. | TRANSPORT OF HORSES..... | 29 |
| 7. | VENUE ARRIVAL INFORMATION & FITNESS TO COMPETE | 29 |
| 8. | EQUINE ANTI-DOPING AND CONTROLLED MEDICATION PROGRAMME (EADCMP). FEI VETERINARY REGULATIONS, | |

| | |
|---|-----------|
| CHAPTER VII | 30 |
| XIII. HUMAN ANTI-DOPING | 31 |
| XIV. ADDITIONAL INFORMATION | 31 |
| 1. THE FEI POLICY FOR ENHANCED COMPETITION SAFETY DURING THE COVID-19 PANDEMIC..... | 31 |
| 2. INSURANCES AND NATIONAL REQUIREMENTS..... | 32 |
| 3. PROTESTS/APPEALS..... | 33 |
| 4. SCHOOLING DURING COMPETITIONS..... | 33 |
| 5. STEWARDING..... | 33 |
| 6. DISPUTES | 34 |
| 7. MODIFICATION TO SCHEDULE | 34 |
| 8. ADDITIONAL INFORMATION FROM THE OC..... | 34 |
| 9. PRIZE MONEY DISTRIBUTION..... | 36 |
| 10. MAXIMUM NUMBER OF STARTERS PER COMPETITION | 37 |
| 11. GLOSSARY | 38 |
| XV. ANNEXES..... | 40 |

III. THE FEI CODE OF CONDUCT FOR THE WELFARE OF THE HORSE

The Fédération Equestre Internationale (FEI) expects all those involved in international equestrian sport to adhere to the FEI's Code of Conduct and to acknowledge and accept that at all times the welfare of the horse must be paramount and must never be subordinated to competitive or commercial influences.

1. At all stages during the preparation and training of competition horses, welfare must take precedence over all other demands. This includes good horse management, training methods, farriery and tack, and transportation.
2. Horses and Athletes must be fit, competent and in good health before they are allowed to compete. This encompasses medication use, surgical procedures that threaten welfare or safety, pregnancy in mares and the misuse of aids.
3. Events must not prejudice horse welfare. This involves paying careful attention to the competition areas, ground surfaces, weather conditions, stabling, site safety and fitness of the horse for onward travel after the event.
4. Every effort must be made to ensure that horses receive proper attention after they have competed and that they are treated humanely when their competition careers are over. This covers proper veterinary care, competition injuries, euthanasia and retirement.
5. The FEI urges all involved with the sport to attain the highest levels of education in their areas of expertise.

The Long version of this Code can be obtained from the Fédération Equestre Internationale, HM King Hussein I Building, Chemin de la Joliette 8, 1006 Lausanne, Switzerland. Telephone: +41 21 310 47 47. The Code is available in English. The Code is also available on the FEI's website: <http://inside.fei.org/>.

IV. GENERAL INFORMATION

1. ORGANISER

Name: Hipodrom Sopot sp. z o.o.
Address: Polna 1, 81-745 Sopot
Telephone: +48 58 551 78 96
Fax: -
Email: csio@csio.sopot.pl
Website: www.csio.sopot.pl

Contact Details Show Ground:

Address: Łokietka 1, 81-745 Sopot
Telephone: +48 551 78 96
GPS Coordinates: Łokietka/Rybacka/Gospody corner 54°25'29" North / 18°34'37" East
Accessibility details (directions by road, nearest airport / train station):
NEAREST AIRPORT - LECH WALESIA AIRPORT
--> www.airport.gdansk.pl

NEAREST LOCAL TRAIN STATION - SOPOT WYŚCIGI
--> www.skjm.pkp.pl

NEAREST INTERNATIONAL TRAIN STATION - GDAŃSK GŁÓWNY
--> www.pkp.pl

2. ORGANISING COMMITTEE

Honorary President: Jacek Karnowski Mayor of Sopot City
President of the Event: Kaja Koczurowska Wawrzekiewicz
Show Secretary: Anna Kniejska
Press Officer: Agnieszka Maziarka

3. EVENT DIRECTOR

Name: Kaja Koczurowska Wawrzekiewicz
Telephone: +48 602 390 230
Email: kkoczurowska@sopot.pl

SPORT DIRECTOR

Name: Rudiger Wassibauer
Telephone: +48 530 729 055
Email: wassibauer@wp.pl

4. STABLE MANAGER

Name: Marcin Wantke
Telephone: +48 607 996 575
Email: marcinwantke@gmail.com

5. ANNOUNCER

Name: Andrzej Cieślak / Dorothy Sabova
Email: cieslakowie@poczta.oet.pl / dorothy.sabova@gmail.com

V. OFFICIALS

| Ref. | Panel | Function | FEI ID | Name | NF | Level | E-mail & Mobile |
|------|----------------------------|---------------------------------|----------|-------------------------|---------|-------|---|
| 1 | Ground Jury | Ground Jury President | 10048844 | Joachim Geilfus | GER | 4 | jg@geilfus-gmbh.de +49 172 5637690 |
| | | Ground Jury Member | 10049773 | Tomasz Mossakowski | POL | 3 | |
| | | Ground Jury Member | 10083948 | Agata Komorowska | POL | 3 | |
| | | Ground Jury Member | 10149409 | Małgorzata Chajęcka | POL | 2 | |
| | | Ground Jury Member | 10079796 | Ewa Porębska Gomółka | POL | 2 | epogo@go2.pl |
| 2 | Foreign Judge | Foreign Judge | 10048837 | Bruno Laubscher | SUI | 3 | |
| 3 | Foreign Technical Delegate | Foreign Technical Delegate | | | | | |
| 4 | Course Designer | Course Designer | 10052103 | Szymon Tarant | POL | 3 | tarantevents@gmail.com +48 604 074 933 |
| | | Assistant Course Designer | 10147414 | Arkadiusz Weckwert | POL | 2 | arek.w@poczta.onet.pl |
| | | Assistant Course Designer | | Bartosz Skrzypczyk | POL | N | +48 530 023 533 |
| | | Assistant Course Designer | | Robert Musiał | POL | N | |
| | | Assistant Course Designer | | Piotr Staniszewski | POL | N | |
| | | Assistant Course Designer | | Grzegorz Wojtaczka | POL | N | |
| | | Assistant Course Designer | | Sebastian Mołga | POL | N | |
| 5 | Chief Steward | Chief Steward | 10052984 | Zbigniew Seibt | POL | 3 | Zas.s@interia.pl +48 783 872 616 |
| 6 | Foreign Steward | Foreign Steward | 10093801 | Orla Griffin | IRL | 3 | |
| 7 | Assistants Stewards | Assistant Steward | 10052979 | Sylwia Bogacz | POL | 3 | |
| | | Assistant Steward | 10140023 | Anna Bosiacka | POL | 2 | |
| | | Assistant Steward | 10119851 | Justyna Olszak | POL | 2 | |
| | | Assistant Steward | 10116088 | Aleksandra Tutaj | POL | 3 | |
| 8 | FEI Veterinary Delegate | FEI Veterinary Delegate | | | | | |
| | Veterinary Commission | Veterinary Commission President | 10049846 | Janusz Okonski | POL | 3 | +48 602 101 283 |
| | | Foreign Veterinary Delegate | 10053654 | Hallvard Sommerseth | UAE/NOR | | hallsom@online.no |
| | | Assistant FEI Delegate | 10048907 | Michał Grundwald | POL | 3 | +48 602 231 314 |

FEI APPROVED SCHEDULE
CSIO5* Sopot (POL) 17-20 June 2021



| | | | | | | | |
|----|---|-------------------------------------|----------|-----------------------------------|-----|---|---|
| 9 | Veterinary Service Manager (VR Art 1103) / Treating Veterinarian (VR Art 1105) | Veterinary Service Manager | 10049570 | Piotr Szpotański | POL | 2 | +48 512220709 |
| | | FEI Permitted Treating Veterinarian | 10150949 | Sebastian Maj | POL | | +48 502 657 021 |
| 10 | Medical Doctor | Medical Doctor | | Sadowski Radowit NORDAMBULANSE | POL | | sadowski@nordambulanse.pl +48 608 765 630 |
| 11 | Farrier | Farrier | | Adam Hebel | POL | | +48 797 087 222 |
| 12 | NF Delegate | NF Delegate (if applicable) | | | | | |

Please note that the schedule has been approved under the provision that all appointed Officials have successfully passed the on-line FEI Competency Evaluation Test.

VI. INVITATIONS

1. GENERAL

Horses entered in one CSI star level may not enter another CSI star level at the same Event.

Horses may take part in national Competitions and international Competitions at the same Event only under the following conditions:

- Horses may take part in national Events up to two hours prior to the start of the international Event's Horse Inspection;
- If the national Event includes Competitions after the international Event ends, either on the same day or on the following day(s). Horses having taken part in the international Event may take part in national Competitions only, following the conclusion of the international Event.

Invitations

For all Events at which the CSI Invitation Rules apply, a certain percentage of Athletes must be invited in descending order of the Longines Ranking, a certain percentage of Athletes will be home Athletes selected by the host NF and a certain percentage will be Athletes invited by the Organising Committee (OC); the percentages for each invitation group are established for each star level as follows:

| Event Level | Athletes from the Longines Ranking | Athletes selected by the host NF | OC Invitations |
|---|---|----------------------------------|----------------|
| CSI 5* | 60% | 20% | 20% |
| CSI 4* | 50% | 25% | 25% |
| CSI 3* | 40% | 30% | 30% |
| CSI 2* | 30% | 30% | 40% |
| CSI 2* Open, option with no Longines Ranking Competitions if the number of invited Athletes is restricted | 0% | 20% | 80% |
| CSI 2* Open, option with no Longines Ranking Competitions if the number of invited Athletes is unrestricted | N/A, CSI Invitation Rules do not apply to CSI Events at which the number of Athletes invited is not restricted. | | |

If an OC decides not to limit the number of Athletes, no limit can be set on the maximum number of horses and all entries will therefore automatically be accepted.

Longines Rankings

The Longines Rankings number , established three (3) months prior to this Event will be used for the invitation of Athletes. Athletes are invited through the FEI online Invitation System for Jumping in accordance with the CSI Invitation Rules (refer to Jumping Rules Annex V)

CSI star level:

Maximum number of Athletes to be invited:

Maximum number of Horses that may be entered:

Maximum number of Horses per Athlete:

| Maximum number of Athletes invited | No. of Athletes from the Longines Ranking | No. of Athletes selected by the host NF | No. of OC Invitations |
|------------------------------------|---|---|-----------------------|
| | | | |

(OCs will be permitted to invite a limited number of additional Athletes, if, at the closing of entries, the maximum number of Horses that may be entered has not been reached. For details, please see the "Implementation of the FEI Online Invitation System for Jumping Guidelines".)

CSI star level:

Maximum number of Athletes to be invited:

Maximum number of Horses that may be entered:

Maximum number of Horses per Athlete:

| Maximum number of Athletes invited | No. of Athletes from the Longines Ranking | No. of Athletes selected by the host NF | No. of OC Invitations |
|------------------------------------|---|---|-----------------------|
| | | | |

(OCs will be permitted to invite a limited number of additional Athletes, if, at the closing of entries, the maximum number of Horses that may be entered has not been reached. For details, please see the "Implementation of the FEI Online Invitation System for Jumping Guidelines".)

FEI Wild Cards:

CSI5*: 1

CSI4*/CSI3*/CSI2*: 2

Connected Events:

| | |
|--------------------------|-------------------|
| Invitation System Event: | Connected Events: |
| Invitation System Event: | Connected Events: |

There are no connected Events in this show ☒

Section 1: Compulsory Invitations

Athletes can choose Events for which they wish to receive an information from the Monday eight weeks prior to the week of the Event until midnight GMT on the 4th Sunday prior to the Event.

Section 2: Home Athletes selected by the host NF

Entries for home Athletes in this section must be made through the FEI Entry System between the Monday eight weeks prior to the week of the Event until midnight GMT on the 3rd Wednesday prior to the week of the Event.

Section 3: OC Invitations

Entries in the OC Invitation Quota can be made in the FEI Entry System from the Monday eight weeks prior to the week of the Event up until the closing date for regular entries (the closing date for regular entries cannot be earlier than the 3rd Thursday prior to the week of the Event, and no later than four days prior to the Event) as indicated in the Schedule.

Events for which the Schedule states that overseas air transportation of Horses will be provided/organised by the OC are, for logistical reasons, authorised to establish the closing date for entries at the earliest on the 5th Sunday prior to the event.

CSIO star level:

| | |
|--|--|
| NF's invited with a Team: | BEL, FRA, GBR, GER, IRL, ITA, MAR, NOR, POL, USA, EGY, CZE |
| Reserve NFs for Teams: | 65 + 2 for small tour only to fulfill quota |
| Total number of athletes: | 3 |
| Number of Individual home athletes: | 10 |
| Number of horses per athlete: | 4 |
| Number of Teams: | 0 |
| Number of athletes per team: | 2 |
| Number of individual athletes per NF represented by a Team: | 1 (MAR) |
| Number of Individual athletes per NF not represented by a Team (max 2): | 2 |
| FEI Team Wild Card: | 2 |
| FEI Individual Wildcards (max 2) | |

For FEI Nations Cup™ European Division 1 Events only: The Longines Rankings number 243, established eight weeks prior to the start of the Event, will be used for the invitation of the five athletes from the top 30.

Athletes are invited by the Organiser through their National Federation.

One (1) groom per athlete.

Square for organiser/NF to include special provisions for restrictions related to Athlete/horse participation

VII. ENTRIES

IMPORTANT

- Entries must be made by NFs through the FEI Entry System for all categories of this Event (<https://invitation.fei.org/login>);
- Additional documentation can be found at: <https://inside.fei.org/fei/your-role/it-services/fei-entry-system/fei-entry-system-jumping>;
- All Athletes and Horses participating in any International Competition must be registered with the FEI;
- Athletes and/or Horses present at the Event without having been entered through the FEI's Online Entry System will be automatically disqualified unless compelling circumstances warrant otherwise.

1. Each horse is allowed to participate once a day only
2. Each horse is allowed to participate in maximum three competitions during this event

Please be aware while driving in Poland ELECTRONIC TOLL COLLECTION SYSTEM "viaTOLL" is in charge. For more information please visit <https://www.viatoll.pl/en/homepace> for organiser to include details if necessary

1. ENTRY DATES AND ENTRY FEES

Entries have to be in accordance with Art.251 of the FEI Jumping Rules, 26th edition, updates effective 1 January 2021

Deadlines for Entries:

Nominated Entries:

(NB: Nominated Entries apply to Championships and Games **ONLY**)

Definite Entries: **07.06.2021**

Definite entries POL 04.06.2021

Last date for substitutions: **16.06.2021 1h before the HI**

Entry fee per horse (per category):

VAT excluded

CSIO

550 EUR / 2475 PLN (VAT excluded)

VAT (in %) : **8**

Please refer to definition of Entry fees and Compulsory fees in the Glossary of the FEI Jumping Rules 26th edition, updates effective 1 January 2021, that is copied in Section XIV point 10.

Compulsory fees per horse:

- EADCMP Fee: Included in entry fee ☐
Not included in entry fee ☒

Lower Level Events (CIMs) CHF 18 per horse per event
Higher Level Events CHF 25 per horse per event
(For definition of CIMs see Appendix E of the FEI General Regulations, all other events not defined as CIMs)

- Fee for manure disposal (at OC discretion; maximum € 40 per horse per Event). 180 PLN (i.e. 40 eur) Per horse
- Fee for health/customs-related documents for Horses, if applicable (only if requested) 110 PLN (i.e. 25 eur) Per horse

All aforementioned amounts are including VAT

Total maximum fee per horse: 290 PLN + EADCMP

Compulsory fees per athlete:

- NF fee if applicable 0 PLN Per athlete
- NF medication control programme fee if applicable 0 PLN Per athlete
- Fee for lorry parking if applicable 0 PLN Per lorry/caravan
- Fee for electric hook-up for lorry 350 PLN Per lorry/caravan

All aforementioned amounts are including VAT

Total maximum fee per Athlete: 350 PLN (i.e. 80 eur)

2. OTHER FEES

All other fees must optional fees and be listed hereunder with the details of the amounts to be charged and approved by the FEI. Only fees approved by the FEI and listed in the approved Schedule can be charged by the OC. *Please specify if price per bale or other quantity.*

Hay: free of charge

Straw: free of charge

Shavings: free of charge for the first bedding - 3 packs (~20kg), for more you have to pay additionally 80zł per pack

Other (please specify): TACK BOX (ONLY UPON REQUEST IN ENTRIES): 500 PLN per show (apx. 115 eur); Additional day for horse: 150 PLN per day (apx. 35eur)

All aforementioned amounts are including VAT

VAT number of the organiser: PL 585-10-01-930

3. NO-SHOWS/LATE WITHDRAWALS

NB: In the case of withdrawals after the date of definite entries or no-shows the athlete or the respective NF will be held liable to reimburse the OC for the actual financial loss incurred by the OC (i.e. stabling and hotel expenses) as a result of the late withdrawal or no-show.

Amount charged: 1450 PLN or eur equivalent (apx. 325 eur)

General information:

- all Athletes are required to fill out the account details in the show office on the arrival

Payments should be done before arrival to the:

Hipodrom Sopot sp z o.o.

Polna 1

81-745 Sopot, Polska

PKO Bank Polski S.A.

o/POB

PLN

73 1440 1101 0000 0000 1146 9353

EURO

SWIFT CODE (BIC) BPKOPLPW

54 1440 1101 0000 0000 1268 9567

VIII. TIMETABLE

Competitions must not start before 08:00 and must not finish after 23:00, unless prior approval is granted by the FEI.

As per Jumping Rules Annex VI: combined competitions are not permitted.

The scheduling of competitions must take into account mandatory maintenance breaks as follows. In principle, there should be one maintenance break for every 40 starters; at a minimum, it is compulsory to include one maintenance break in competitions with 50-99 starters after half of the starters have competed. Competitions with 100 starters or more must have three maintenance breaks. The start list must indicate when the maintenance break will take place (e.g. after N° 25).

Competitions CSIO5*:

| | Day | Date | Time |
|---|-----------|-------|--|
| • Opening of stables | Wednesday | 16.06 | 12:00 |
| • Horse Inspection <u>ALL HORSES ENTERING THE VENUE MUST BE PRESENTED at the inspection as well as the non-competing horses.</u> | | | 17:00-19:15 geldings, mares 19:30-20:15 stallions only |
| • Declaration of starters | | | 19:00 the latest |
| • Horse Re-Inspection | Thursday | 17.06 | 07:15-07:30 |
| • Chefs d'Equipe Meeting at CSIO's (FEI Jumping Rules article 253) GP Draw | | | 45 min. after last class of the day |
| • Gala Dinner | Friday | 18.06 | |
| • Chef d'Equipe Meeting at CSIO's – FEI NC Draw (art. 264.6 Jumping Rules) | Friday | 18.06 | DURING GALA DINNER |

Competitions CSIO5*:

| Competitions CSIO5*: | Day | Date | Time | Art | Prize Money |
|---|----------|-------|-------------------|--------------------|---------------|
| • 30 min. Horse exercise at warm up | Thursday | 17.06 | 1h before class 1 | | |
| • 1 - CSIO; 140cm; in 2 phases | | | 09.00 | 274.1.5.3 | 20.000 PLN |
| • 2 - CSIO; 145cm; in 2 phases; (LR D) | | | following | 274.1.5.3 | 100.000 PLN |
| • 3 - CSIO; 150cm; against the clock; (GP Q)(LR D) | | | following | 238.2.1 | 100.000 PLN |
| • 30 min. Horse exercise at warm up | Friday | 18.06 | 1h before class 4 | | |
| • 4 - CSIO; 140cm; against the clock | | | 09.00 | 238.2.1 | 20.000 PLN |
| • 5 - CSIO; 160cm; Longines Grand Prix (LR A) | | | 16:00 | 273.2.2.2 | 660.000 PLN |
| | | | | (ii), 273.3.3.1 | |
| • 30 min. Horse exercise at warm up | Saturday | 19.06 | 1h before class 6 | | |
| • 6 - CSIO; 145cm; against the clock; | | | 09.00 | 238.2.1 | 20.000 PLN |
| • 8 - CSIO; 160cm; against the clock; (LR D) | | | following | 238.2.2 | 100.000 PLN |
| • 7 - CSIO; 150cm; in 2 phases; | | | following | 274.1.5.3 | 20.000 PLN |
| • 30 min. Horse exercise at warm up | Sunday | 20.06 | 1h before class 9 | | |
| • 9 - CSIO; 150cm; against the clock | | | 09.00 | 238.2.1 | 20.000 PLN |
| • 10- CSIO; Longines FEI Jumping Nations Cup™ of Poland 160cm; (LR HH) (TV) | | | 11.00 | 264 | 1.120.000 PLN |
| • Total Prize Money CSIO | | | 2.180.000 PLN | | |
| • Prizes in Kind | N/A | | | | |

Overall Prize Money: 2.180.000 PLN

Applicable government tax to be deducted from Prize Money (see also XIV.8): **10%**

GENERAL CLASSIFICATION AT THE END OF THE COMPETITIONS:

Best lady athlete in Grand Prix -
Best home athlete in Grand Prix –
Double Clear in Nations Cup -

CUP of Farys Design
CUP of Konska Cukierenka
CUP of Torpol

PRIZE – CLASSIFICATION:

IX. COMPETITION DETAIL

FIRST DAY : Thursday

DATE: 17.06.2021

COMPETITION No:1

Time: 09:00

Type of Competition: in two phases both against the clock
Acc. to Article: 274.1.5.3

| | |
|------------------------------|---|
| Jump-off (if any) | no |
| Speed/Fixed time | 350 m/min |
| Height of obstacles: | 140 cm |
| Number of horses per athlete | 1 |
| Number of Starters: | 67 |
| Total prize money: | 20.000 PLN |
| Chart to be used: | 1 (25% to winner) <input checked="" type="checkbox"/> |
| | 2 (33% to winner) <input type="checkbox"/> |

Please specify prize money amount for each athlete placed 13th and beyond: 100 PLN
* * * * *

COMPETITION No:2

Time: following

Type of Competition: in two phases both against the clock
Acc. to Article: 274.1.5.3

Competition description: **LR group D**

| | |
|------------------------------|---|
| Jump-off (if any) | no |
| Speed/Fixed time | 350 m/min |
| Height of obstacles: | 145 cm |
| Number of horses per athlete | 1 |
| Number of Starters: | 67 |
| Total prize money: | 100.000 PLN |
| Chart to be used: | 1 (25% to winner) <input checked="" type="checkbox"/> |
| | 2 (33% to winner) <input type="checkbox"/> |

Please specify prize money amount for each athlete placed 13th and beyond: 250 PLN
* * * * *

COMPETITION No:3

Time: following

Type of Competition: Table A against the clock
Acc. to Article: 238.2.1

Competition description: **Grand Prix qualifier, LR group D**

| | |
|------------------------------|-------------|
| Jump-off (if any) | no |
| Speed/Fixed time | 350 m/min |
| Height of obstacles: | 150 cm |
| Number of horses per athlete | 1 |
| Number of Starters: | 67 |
| Total prize money: | 100.000 PLN |

Chart to be used: 1 (25% to winner) ☒ **x**
2 (33% to winner) ☐

Please specify prize money amount for each athlete placed 13th and beyond: 250 PLN

* * * * *

SECOND DAY : Friday

DATE: 18.06.2021

COMPETITION No:4

Time: 09:00

Type of Competition: against the clock
Acc. to Article: 238.2.1

Jump-off (if any) no
Speed/Fixed time 350 m/min
Height of obstacles: 140 cm
Number of horses per athlete 1
Number of Starters: 67
Total prize money: 20.000 PLN
Chart to be used: 1 (25% to winner) ☒ **x**
2 (33% to winner) ☐

Please specify prize money amount for each athlete placed 13th and beyond: 100 PLN

* * * * *

COMPETITION No: 5

Time: 16:00

Type of Competition: **LONGINES GRAND PRIX**
Acc. to Article: 273.2.2.2 (ii) Art 273.3.3.1 and Art 273.4.3 + FEI Olympic Regulations Art. 632.6.1 + JRs Annex VIII, Art. 3.11 & 4.11

This competition counts for the Longines Ranking Group A

Qualifier for the Tokyo 2021 Olympic Games / CH-EU-S 2021 / CH-M-S 2022 (Certificate of Capability)

Competition description: Over two rounds Table A against the clock
25% of athletes return for 2nd round based on penalties and time in 1st round.
Athletes are placed according to penalties in both rounds and time in 2nd round.
Athletes not taking part in the second round will be placed according to the Penalties and time in the first round. In any case all athletes without penalties in the first round return for the second round.

Jump-off (if any) no
Speed/Fixed time 400 m/min
Height of obstacles: 160 cm (2 verticals 1.60m compulsory)
Number of horses per athlete 1
Number of Starters: 50
Total prize money: 660.000 PLN
Chart to be used: 1 (25% to winner) ☒ **x**
2 (33% to winner) ☐

Please specify prize money amount for each athlete placed 13th and beyond: 600 PLN

Qualification system: Art 10 of Longines FEI Nation Cup™ rules 2021

All official team members (maximum 40 – 10 teams with four members per team are automatically qualified for the Grand Prix.)

The following are automatically qualified for the Grand Prix, if present as official team members or individuals:

- The individual Jumping medal winners (Athletes) of the last Olympic and Pan American Games, and World and Continental Championships, as well as the first placed Athlete/Horse combination in the last FEI World Cup™ Jumping Final.
- The winners (Athlete/Horse combination) of the Grand Prix at any CSIO5* event during the previous 12 months.
- The best athletes, not already qualified, qualify from competition 3 to reach the 50 starters in total. The rider has to finish the class.
- If already qualified rider neglect or cannot start in Grand Prix the next eligible rider will be chosen from class no 3, however no later than one hour prior to the Grand Prix

All Athletes taking part in a Grand Prix at a CSIO or a CSI must have completed, with their Grand Prix Horse, the initial round of at least one competition prior to the Grand Prix.

Counting for Tokyo Olympic Games 2021 / CH-EU-S 2021

This competition will count as a competition where athletes and horses can achieve the Minimum Eligibility Requirements (MER) providing the course meets the following specifications: consist of at least 12 obstacles which may vary in height between 1.40m and 1.60m. The spread obstacles must have spreads of between 1.50m to 2.00m (2.20m for the triple bar). At least two vertical obstacles must be provided with a minimum height of 1.60m.

Counting for CH-M-S 2022

*This competition will count as a competition where athletes and horses can achieve the Minimum Eligibility Requirements (MER) providing the course meets the following specifications: consist of at least 12 obstacles which may vary in height between 1.40m and 1.60m. The spread obstacles must have spreads of between 1.50m to 2.00m (2.20m for the triple bar). At least two vertical obstacles must be provided with a minimum height of 1.60m. In addition to these requirements the competition must comply with the following **mandatory requirements** to count for the CH-M-S 2022:*

- *The first obstacle may be a vertical minimum height 1m45 or an oxer minimum height 1m40 for the front pole and 1m45 for the back pole;*
- *One set of planks on flat cups;*
- *Triple bar minimum 1m80 spread and 1m50 height;*
- *One wall or gate;*
- *One narrow vertical or spread obstacle with frontal width between 2m50 to 3m00;*
- *Minimum one triple and one double combination (three doubles are not allowed);*
- *The triple combination must have at least one oxer minimum 1m50 height and 1m50 spread, and at least one one-stride distance either from A to B or from B to C;*
- *Approximately 50% of the efforts must be vertical obstacles and 50% must be spread obstacles (e.g. oxer, triple bar, Swedish oxer, narrow oxer etc.). Nevertheless, no more than 55% of the efforts may be vertical and no more than 60% of the efforts may be spread obstacles, including the water jump if there is one;*
- *Two verticals (other than the wall) must have a height of 1m60;*
- *At least two spread obstacles with minimum height of 1m50 and minimum spread of 1m60;*
- *Two liverpool obstacles, one vertical and one spread. If the course includes a water jump, a minimum of one liverpool will be allowed;*
- *Bend or straight line of up to six strides between two single obstacles;*
- *Depth of cups: minimum 50% of cups must have a depth of 18mm; depth of cups maximum 20mm if poles are 350-400cm long;*

- *Minimum length of course 400 meters with a minimum speed of 375m/min;*
- *The course will include minimum 12 and maximum 14 obstacles.*

The Foreign Judge is responsible for ensuring that the course is built to the required dimensions and must confirm to the FEI through the Foreign Judge Report whether or not the course requirements have been met and must upload/sent the course plan including all heights and dimensions following the Event.

* * * * *

THIRD DAY : Saturday

DATE: 19.06.2021

COMPETITION No: 6

Time: 09:00

Type of Competition: against the clock

Acc. to Article: 238.2.1

| | | |
|------------------------------|-------------------|-------------------------------------|
| Jump-off (if any) | no | |
| Speed/Fixed time | 350 m/min | |
| Height of obstacles: | 145 cm | |
| Number of horses per athlete | 1 | |
| Number of Starters: | 67 | |
| Total prize money: | 20.000 PLN | |
| Chart to be used: | 1 (25% to winner) | <input checked="" type="checkbox"/> |
| | 2 (33% to winner) | <input type="checkbox"/> |

Please specify prize money amount for each athlete placed 13th and beyond: 150 PLN

* * * * *

COMPETITION No:8

Time: following

Type of Competition: against the clock with one jump off

Acc. to Article: 238.2.2

Competition description: **LR group D**

| | | |
|------------------------------|-------------------|-------------------------------------|
| Jump-off (if any) | yes | |
| Speed/Fixed time | 350 m/min | |
| Height of obstacles: | 160 cm | |
| Number of horses per athlete | 1 | |
| Number of Starters: | 67 | |
| Total prize money: | 100.000 PLN | |
| Chart to be used: | 1 (25% to winner) | <input checked="" type="checkbox"/> |
| | 2 (33% to winner) | <input type="checkbox"/> |

Please specify prize money amount for each athlete placed 13th and beyond: 250 PLN

* * * * *

COMPETITION No: 7

Time: following

Type of Competition: in two phases both against the clock

Acc. to Article: 274.1.5.3

| | | |
|------------------------------|-------------------|-------------------------------------|
| Jump-off (if any) | no | |
| Speed/Fixed time | 350 m/min | |
| Height of obstacles: | 150 cm | |
| Number of horses per athlete | 1 | |
| Number of Starters: | 67 | |
| Total prize money: | 20.000 PLN | |
| Chart to be used: | 1 (25% to winner) | <input checked="" type="checkbox"/> |
| | 2 (33% to winner) | <input type="checkbox"/> |

Please specify prize money amount for each athlete placed 13th and beyond: 150 PLN

* * * * *

FOURTH DAY : Sunday

DATE: 20.06.2021

COMPETITION No:9

Time: 09.00

Type of Competition: against the clock
Acc. to Article: 238.2.1

| | |
|------------------------------|---|
| Jump-off (if any) | no |
| Speed/Fixed time | 350 m/min |
| Height of obstacles: | 1m50 |
| Number of horses per athlete | 2 |
| Number of Starters: | 100* (if more than 100 take part then please refer to |
| Section XIV point 9) | |
| Total prize money: | 20.000 PLN |
| Chart to be used: | 1 (25% to winner) <input checked="" type="checkbox"/> |
| | 2 (33% to winner) <input type="checkbox"/> |

Please specify prize money amount for each athlete placed 13th and beyond: 150 PLN

* * * * *

COMPETITION No:10

Time: 11:00

LONGINES FEI NATIONS CUP™ OF POLAND

**Art.264 + FEI Olympic Regulations Art. 632.6.1 + JRs Annex VIII, Art. 6 3.11 & 4.11 +
FEI Nations Cup™ Rules – CSIO*******

This competition counts for the Longines Ranking Group HH

Qualifier for Tokyo 2021 Olympic Games / CH-EU-S 2021 / CH-M-S 2022 (Certificate of Capability).

LIVE TV COVERAGE

Competition description: Over two identical rounds judged under Table A not against the clock in the first round, against the clock in the second round, with a time allowed in both rounds with a jump off if required

The starting order in the 1st round will be established by a draw.

| | |
|---------------------------------|---|
| Jump-off (if any) | one |
| Speed | 400 m/min |
| Height of obstacles: | 1m60 (2 verticals 1m60 compulsory) |
| Number of horses per athlete | 1 |
| Maximum number of TEAMS: | 10 |
| Number of teams in second round | 10 |
| Total prize money: | 1.120.000 PLN |

TEAMS prize money: **890.000** PLN

1st place 32%

| | |
|------------------------|------|
| 2 nd place | 20% |
| 3 rd place | 16% |
| 4 th place | 12% |
| 5 th place | 8% |
| 6 th place | 5.5% |
| 7 th place | 4% |
| 8 th place | 1.5% |
| 9 th place | 0.5% |
| 10 th place | 0.5% |

INDIVIDUAL'S prize money: 230.000 PLN

Prize money to the rider(s) with the best performance in both rounds of the FEI Nations Cup™

The starting order of the Teams in the 2nd round will be in the reverse order of the total penalties in the first round of the best 3 Athletes in each team. In case of equality of penalties the teams will retain the starting order of the first round. In case of equality of penalties for 1st place after the 2nd round there will be a jump-off with one rider per team. All teams qualified for the second round receive prize-money.

Teams not in the jump-off are placed according to their penalties in both round and the times of their 3 best riders in the second round.

Counting for Tokyo Olympic Games 2021 / CH-EU-S 2021

This competition will count as a competition where athletes and horses can achieve the Minimum Eligibility Requirements (MER) providing the course meets the following specifications: consist of at least 12 obstacles which may vary in height between 1.40m and 1.60m. The spread obstacles must have spreads of between 1.50m to 2.00m (2.20m for the triple bar). At least two vertical obstacles must be provided with a minimum height of 1.60m.

Counting for CH-M-S 2022

*This competition will count as a competition where athletes and horses can achieve the Minimum Eligibility Requirements (MER) providing the course meets the following specifications: consist of at least 12 obstacles which may vary in height between 1.40m and 1.60m. The spread obstacles must have spreads of between 1.50m to 2.00m (2.20m for the triple bar). At least two vertical obstacles must be provided with a minimum height of 1.60m. In addition to these requirements the competition must comply with the following **mandatory requirements** to count for the CH-M-S 2022:*

- The first obstacle may be a vertical minimum height 1m45 or an oxer minimum height 1m40 for the front pole and 1m45 for the back pole;
- One set of planks on flat cups;
- Triple bar minimum 1m80 spread and 1m50 height;
- One wall or gate;
- One narrow vertical or spread obstacle with frontal width between 2m50 to 3m00;
- Minimum one triple and one double combination (three doubles are not allowed);
- The triple combination must have at least one oxer minimum 1m50 height and 1m50 spread, and at least one one-stride distance either from A to B or from B to C;
- Approximately 50% of the efforts must be vertical obstacles and 50% must be spread obstacles (e.g. oxer, triple bar, Swedish oxer, narrow oxer etc.). Nevertheless, no more than 55% of the efforts may be vertical and no more than 60% of the efforts may be spread obstacles, including the water jump if there is one;
- Two verticals (other than the wall) must have a height of 1m60;
- At least two spread obstacles with minimum height of 1m50 and minimum spread of 1m60;

- *Two liverpool obstacles, one vertical and one spread. If the course includes a water jump, a minimum of one liverpool will be allowed;*
- *Bend or straight line of up to six strides between two single obstacles;*
- *Depth of cups: minimum 50% of cups must have a depth of 18mm; depth of cups maximum 20mm if poles are 350-400cm long;*
- *Minimum length of course 400 meters with a minimum speed of 375m/min;*
- *The course will include minimum 12 and maximum 14 obstacles.*

The Foreign Judge is responsible for ensuring that the course is built to the required dimensions and must confirm to the FEI through the Foreign Judge Report whether or not the course requirements have been met and must upload/sent the course plan including all heights and dimensions following the Event.

X. FACILITIES OFFERED

1. ATHLETES

Accommodation

Hotel:

Address:

Telephone:

At the expense of: The Organiser ☐ or Athletes ☐
Accommodated (bed and breakfast) from to

Meals

At the expense of: The Organiser ☐ or Athletes ☐
Meals provided from to .

Space for organiser to include details if necessary

2. GROOMS

Accommodation.

Requests for accommodation must be sent with entries.

At the expense of: The Organiser ☐ or Athletes ☐
Accommodated (bed and breakfast) from to

Accommodation at OC expense from 16-21 06

Meals.

At the expense of: The Organiser ☐ or Athletes ☐
Meals provided from to .

Space for organiser to include details if necessary

NB: If applicable, Organiser must provide proper sanitary conditions. The showering facilities should be sufficient for both male and female grooms with hot and cold water. Shower facilities as well as restrooms should at all times be in a state of cleanliness.

| | Accommodation | Lunch & Dinner | |
|-------------------------------|-----------------------------|---|--|
| | Radisson Blue Sopot | 5* Club VIP Tent at main arena | Unicorn Restaurant at Indoor Arena |
| Team athlete | 16- 21 06. At OC expense | 17- 20 06. At OC expense | 14-15 06. At Athlete expense 16 06 at OC expense |
| Chef d' equipe | 16- 21 06. At OC expense | 17- 20 06. At OC expense | 14-15 06. At Athlete expense 16 06 at OC expense |
| Individual CSIO athlete | - | 17-20 06. At OC expense | 14-15 06. At Athlete expense 16 06 at OC expense |
| Team groom | - | - | 14-15 06. At Athlete expense 16-20 06 At OC Expense |
| Individual CSIO athlete groom | - | - | 14-20 06. At Athlete expense |
| Team Veterinarian | 16- 21 06. At OC expense | Meals from 16 to 20 06. at OC expense (Art 200.6.1.3) | |

Recommended Hotels:

Golden Tulip <http://www.goldentulipgdanskresidence.com>

Sopot Focus Hotel Premium <http://www.focushotels.pl/sopot,150.html>

XI. LOGISTICAL/ADMINISTRATIVE/TECHNICAL INFORMATION

1. DRAW

List of Draws, time, date and location:

Grand Prix – Thursday 45min after the last class of the day

FEI NC (art. 264.6.1 J.R.) – During Gala Dinner, Friday, 18.06

2. COMPETITION ARENA(S)

Dimensions: 105 x 60
 Type of Footing: fiber sand

3. PRACTICE ARENA(S)

Dimensions: 30 x 70
 Type of Footing: fiber sand

Dimensions: 100 x 60
 Type of Footing: grass

Indoor (flatwork only)
 Dimensions: 80 x 40
 Type of Footing: fiber sand

Riders must have the possibility to exercise their horses in an exercise area under a Steward's supervision at least 30 minutes per day outside of the competition warm-up period. Details of opening times of exercise areas must be included in the timetable.

4. STABLES

Size of boxes 3 m x 3 m (minimum 3m x 3m+20% 3m x 4m)

The following stable security regulations MUST BE obeyed:

- Smoking is strictly prohibited in the entire stable area
- Open fires (e.g. camping stoves) are strictly prohibited
- Only the actually needed amount of feed supplies may be stored in the stables
- Open space and entry ways between the stables may not be obstructed by trucks or lorries
- Horses must be stabled in the boxes assigned to them on the showground within FEI stable area for the duration of the event.
- Horses may not be unloaded on their arrival without authorization of the stable manager.
- Stables can be allocated on arrival but PLEASE MAKE SURE SPECIAL REQUEST (e.g. stallions) with definite entries.
- Entry to the stables between 11.00 PM and 06.30 AM is allowed with authorization of the Stewards only, unless in an emergency
- Horse may not leave their boxes without the head number

5. SAFETY CUPS

Name of Manufacturer: Caro Cardinali & Rothenberger GmbH Germany

6. TIMING DEVICE

Name of Manufacturer: ALGE
Model: TIMY PXE / Photocells: RLS 1n / Wireless transmitters: TED-TX10/RX10
FEI Report number: Timer: 22020008A / Photocells: 22020010B / Wireless transmitters: 22020013C

7. SCORING/TIMING PROVIDER

Will you use a FEI Certified Service Provider to manage the scoring and timing at your Event?

(The list of certified Service Providers is available here: <https://inside.fei.org/fei/your-role/it-services/it-providers/list>)

Yes ☒

Name of the company: Longines Timing / hippo data GmbH

FEI Certified Service Provider ID number: GT11V808AKSCH

Contact person at Event

Name: JENS FETH

FEI ID number: 10081662

Contact email: jf@hippodata.net

No ☐

Name of the company:

Contact person at Event

Name:

FEI ID number:

Contact email: (compulsory)

Please fill in Annex XV – FEI Entry System for the Timing Provider

The FEI may require to be provided with real time results data feed of your Events according to FEI requirements; in this case you and your provider will be informed accordingly.

8. OTHER TECHNOLOGY/SERVICE PROVIDER(S)

Will you use other technology/service provider(s) at your event?

Yes ☐

Name of Company:

Contact person:

Name:

FEI ID number (if applicable):

Contact email:

Activity/Function:

(i.e.: Accreditations, Stable Management, Camera system, Sensors, etc...)

No ☒

9. PRIZE GIVING CEREMONY

The owner of the winning horse/pony must be invited to the prize giving ceremony for the Grand Prix, if present at the event.

The number of athletes required to present themselves for the prize-giving ceremony of each competition is 3.

All Prize Giving Ceremonies must strictly follow the [Covid-19 guidelines for Prize giving protocols and media activities.](#)

10. ADVERTISING ON ATHLETES AND HORSES

At CSI events, and all competitions except for the Nations Cup, athletes are authorised to carry the logo of their personal sponsor in accordance with the articles 256.3 and 257.3 of the FEI Jumping Rules.

The Chief Steward will check that the advertising on athletes and horses complies with these Articles.

11. TICKETING

Are you selling tickets for spectators to attend your event: Yes ☐ No ☒

Name of your ticketing provider:

Web address to buy ticket:

12. BETTING

Betting will be authorised by the Organiser: Yes ☐ No ☒

13. TRANSPORT REIMBURSEMENT HORSES / PONIES

Transport expenses to be paid by:
The Organiser ☐ at _____ per km.
The Athlete ☒

14. WELCOME

The time and date of arrival of athletes, horses and their means of transport must be given to the Organiser in order to facilitate their arrival.

15. LOCAL TRANSPORTATION - ARRANGEMENTS FROM HOTEL TO SHOWGROUNDS

Walking distance ☒

Organiser Shuttle Service ☒

Public Transport ☒ to be paid by the Organiser ☐ / the Athlete ☒

If paid by Athlete approximate cost per round trip: 20 PLN

Other:

16. ENTRY RIGHT TO SHOWGROUNDS/ACCREDITED PERSONS

Entry right to the stable area according to FEI Veterinary Regulations Articles 1008-1009.

NUMBER OF ACCREDITED PERSONS:

Athlete: 1

Partner: 1

Groom: 1

Horse Owner: 2 two (2) accreditations per horse acc. to FEI-Passport

17. SUSTAINABILITY

Please consider the environment when organising an FEI Event. Please find useful information on FEI Sustainability here: <http://inside.fei.org/fei/your-role/organisers/handbook>

XII. VETERINARY MATTERS

1. CUSTOMS FORMALITIES

Contact details for Customs Formalities:

Name: C. HARTWIG
Address: SLASKA 47, GDYNIA
Telephone: +48 58 772 50 00
Fax: -
Email: chg@chg.pl
Opening hours: 07-17

Space for organiser to include details if necessary

2. HEALTH REQUIREMENTS

GENERAL

In accordance with the FEI Code of Conduct for the Welfare of the Horse it is imperative that all Horses at FEI Events are physically fit and free from infectious disease before being allowed to compete.

ENTRY OF HORSES

Required health tests and vaccinations:
Quarantine period:
Specimen Import Licence applied:

VETERINARY CERTIFICATE PROVING THAT THE HORSE DOES NOT SHOW ANY SIGNS OF
HERPES VIRUS INFECTION

For questions or problems, please contact your Government Veterinary Services.

Space for organiser to include details if necessary

3. NATIONAL REQUIREMENTS

If applicable please provide:

Space for organiser to include details if necessary

4. PONIES

FEI Veterinary Regulations, Chapter IX and Annex IX:
For all Pony Events, Ponies must be available for Pony Measurement if requested by the FEI.

5. INJURY SURVEILLANCE

FEI Veterinary Regulations, Chapter VIII:

Horses participating in FEI Events are subject to injury surveillance protocols; and in the event of fatality, a post mortem examination.

6. TRANSPORT OF HORSES

Horses must be fit to travel and be transported in suitable vehicles for the transport of horses. Any government requirements for disease testing and control must be requested well in advance, to ensure that the horse is in compliance by the time of arrival at the border of the country where the Event is taking place. Athletes, or their representatives, have the responsibility to comply with national legislation in both their country of origin and the host nation of the Event. Where necessary athletes must contact local government authorities or veterinary advisors for information regarding animal health requirements and transport legislation. Within the European Union (EU), this includes EU Council Regulation (EC) No 1/2005 concerning the protection of animals during transport within the Member States of the EU.

7. VENUE ARRIVAL INFORMATION & FITNESS TO COMPETE

7.1. PASSPORTS. FEI General Regulations Article 137

For all issues relating to FEI Horse Passports/FEI Recognition Cards please contact your National Federation.

All Horses competing at FEI Events must be registered with the FEI.

FEI Passports or FEI Recognition Cards (for those Horses with a national passport approved by the FEI) are compulsory for FEI Events.

NB: Horses entered in CIMs and in CSIP in their country of residence are not required to have an FEI Passport or FEI Recognition Card but must be properly registered with the FEI and identifiable (GRs 137.2).

Athletes who do not present a Horse's Passport and/or Recognition Card, or one that is not correctly validated or fail to meet other passport requirements will be **subject to Sanctions in accordance with Annex VI of the FEI Veterinary Regulations** and may not be allowed to compete.

NB for Horses permanently resident in a Member State of the European Union: all Horses must have a national EU passport in compliance with EU Regulations to which a FEI Recognition card is applied. The exception to this being Horses in possession of an FEI passport which has been continually revalidated without interruption.

7.2. VACCINATIONS - EQUINE INFLUENZA. FEI Veterinary Regulations Article 1003

Horses competing at FEI Events must comply with the requirements for Equine Influenza vaccination in accordance with the Veterinary Regulations and as summarised below.

| VACCINATION | PROTOCOL | ELIGIBILITY TO ENTER VENUE |
|----------------|--|---|
| Primary Course | 1 st Vaccination: day 0 2 nd Vaccination: day 21-92 | May compete 7 days after the 2 nd Vaccination |
| First Booster | Within 7 months of the 2 nd vaccination of the Primary Course | May compete for 6 months +21 days after the 2 nd vaccination of the Primary Course Must not compete in the 7 days after receiving a vaccination |
| Boosters | MINIMUM: within one year of | Must have been vaccinated |

| | | |
|--|---|---|
| | previous booster vaccination IF COMPETING: must be in the 6 months +21 days of the booster previous vaccination | within 6 months +21 days before arriving at the Event Must not compete in the 7 days after receiving a vaccination |
|--|---|---|

All FEI registered Horses intending to compete at FEI Events (including CIMs) must be vaccinated against Equine Influenza in accordance with these VRs. The exception being if the applicable domestic legislation prevents the use of Equine Influenza vaccines within the relevant territory

7.3. EXAMINATION ON ARRIVAL. FEI Veterinary Regulations Article 1031

On arrival at an Event venue, all Horses must undergo an examination by a veterinarian to confirm their identification from their passport and micro-chip ID (where present), their vaccination status and general health. To protect all horses attending events, any Horse with a questionable health status concerning vaccination, disease or other concerns, must be stabled within the isolation facilities provided by the Organising Committee pending a decision on entering the venue.

7.4. HORSE INSPECTIONS. FEI Veterinary Regulations Articles 1034-1042

All Horses will be assessed for their fitness to compete during the Horse Inspection. Any Horse demonstrating questionable fitness may be referred to the Holding Box for further veterinary examination. Horses not deemed fit to compete by the Inspection Panel will not be permitted to compete.

7.5. LIMB SENSITIVITY EXAMINATION. FEI Veterinary Regulations Articles 1048-1053

All Horses are subject to examination under the protocol for abnormal limb sensitivity throughout the period of an Event. For Jumping that includes, but is not limited to, between rounds and before the Jump Off. Horses may be examined once or on multiple occasions during the Period of an Event.

Horses may be selected for examination under the protocol randomly or they may be targeted. All Horses selected to be tested must submit promptly to the examination or are subject to immediate disqualification. There is no obligation to examine any specific number of Horses at an Event.

8. EQUINE ANTI-DOPING AND CONTROLLED MEDICATION PROGRAMME (EADCMP). FEI VETERINARY REGULATIONS, CHAPTER VII

8.1. SAMPLING. FEI VETERINARY REGULATIONS Chapter VII

All horses competing at FEI Events may be subject to sampling for the presence of Prohibited Substances in accordance with the Anti-Doping and Controlled Medication Regulations (EADCMRs). Horses may be selected for sampling in accordance with obligatory testing, targeted or random sampling procedures. Refer to FEI Financial Charges for details of fees relating to Equine and Human Anti-Doping program (EADCMP), which OCs/NFs have the right to charge to the athlete (applicable for all FEI events worldwide).

8.2. ELECTIVE TESTING. FEI VETERINARY REGULATIONS ARTICLES 1058

Elective Testing may be carried out prior to an Event to check for the presence of Prohibited Substances. Please refer to <https://inside.fei.org/fei/cleansport/horses> for information and details.

XIII. HUMAN ANTI-DOPING

Athletes can be tested at any FEI Event, by the FEI or by other Anti-Doping Organisations with Testing jurisdiction. Organisers will have the responsibility to provide facilities and staff/volunteers to facilitate such Testing if requested by the FEI as outlined in article 22.3 of the FEI's Anti-doping Rules for Human Athletes (ADRHA).

The ADRHA rules are published on the FEI website at <http://inside.fei.org/content/anti-doping-rules>.

XIV. ADDITIONAL INFORMATION

1. THE FEI POLICY FOR ENHANCED COMPETITION SAFETY DURING THE COVID-19 PANDEMIC

The FEI Policy for Enhanced Competition Safety during the Covid-19 Pandemic ("Policy") (<https://inside.fei.org/system/files/FEI%20Policy%20for%20Enhanced%20Competition%20Safety%20during%20the%20Covid-19%20Pandemic%20-%20Effective%201%20July%202020%20-%20Updated%2012%20October%202020.pdf>) is mandatory and applies for any FEI Event taking place **as of 1 July 2020**. The Policy has been developed based on currently accepted best practices by the WHO and US Center for Disease Control (CDC) and will be continually reviewed and updated as more information becomes available. It is not intended to replace the applicable guidance and policies from domestic government and health authorities, but to supplement their recommendations with sport specific considerations.

The OC shall submit the risk assessment and mitigation plan (including name and contact details of the person in charge) to the FEI as an annex to the Event Schedule, **at the latest ten (10) working days before the event's deadline for Definite Entries**.

Events for which the FEI has not received the documented risk assessment and mitigation measures plan in accordance with article 2.1.g) of the Policy **will be removed from the FEI calendar** in accordance with Article 112.3 of the FEI General Regulations.

ASSUMPTION OF RISK / WAIVER OF LIABILITY

In consideration of being allowed to participate in the Event and related activities, all Participants (as defined in the Policy) acknowledge, appreciate, and agree that:

1. Participation includes possible exposure to and illness from infectious diseases including but not limited to COVID-19. While particular rules and personal discipline may reduce this risk, the risk of serious illness and death does exist; and,
2. The Participants knowingly and freely assume all such risks, both known and unknown, even if arising from the negligence of the OC or others, and assume full responsibility for their participation; and,
3. The Participants willingly agree to comply with the stated and customary terms and conditions for participation as regards protection against infectious diseases. If, however, a Participant observes any unusual or significant hazard during his/her presence or participation, the Participant will remove himself/herself from participation and bring such to the attention of the nearest official immediately; and,
4. The Participants, for themselves and on behalf of their heirs, assigns, personal representatives and next of kin, HEREBY RELEASE AND HOLD HARMLESS THE OC AND THE FEI, their officers, officials, agents, and/or employees, other participants,

sponsoring agencies, sponsors, advertisers, and if applicable, owners and lessors of premises used to conduct the event ("RELEASEES"), WITH RESPECT TO ANY AND ALL ILLNESS, DISABILITY, DEATH, or loss or damage to person or property, WHETHER ARISING FROM THE NEGLIGENCE OF RELEASEES OR OTHERWISE, to the fullest extent permitted by law.

The Participants confirm to have read this release of liability and assumption of risk agreement, fully understand its terms, understand that they have given up substantial rights.

2. INSURANCES AND NATIONAL REQUIREMENTS

Equestrian sports involve inherent dangerous risks. To the greatest extent permitted by law, the FEI and the FEI Event Organiser shall NOT be liable for any damages relating to loss of property or injury of any kind to Athletes, Owners, Support Personnel or Horses at or in connection with an FEI Event and the FEI expressly excludes all such liability.

2.1. ATHLETES, OWNERS AND SUPPORT PERSONNEL

2.1.1. Personal Accident and Health Insurance

It is your responsibility as an Athlete/Owner/ Support Personnel to ensure that you have adequate personal accident insurance in place to cover your participation at FEI Events and in particular to insure against any personal injury or medical expenses arising from an accident, injury or illness which may occur at a FEI Event.

You should check with your National Federation to confirm if your National Federation's insurance policy (if any) covers personal accidents and/or illnesses which may occur when you are attending/participating in FEI Events.

If your National Federation does not have a personal accident/health insurance policy or if the National Federation's insurance policy does not cover personal accident or health claims, then you should obtain your own personal accident and health insurance policy to cover your attendance/participation at FEI Events.

2.1.2. Personal Property Insurance

You should also ensure that you are insured against property loss, theft or damage which may occur at an FEI Event.

Again, the advice is to check with your National Federation to confirm if they have an insurance policy in place which would cover you in case of such property loss, theft or damage. If not, then you should obtain your own personal property insurance to cover such situations.

2.1.3. Press Equipment

Press equipment and other items left in the Press workroom, Press lockers, the Press Tribune or anywhere on the showgrounds are left entirely at the owner's risk. The Organising Committee does not accept any responsibility for any loss or damage to such equipment or items. Members of the Press are advised not to leave any equipment or personal items unattended.

2.2. ATHLETES AND OWNERS

2.2.1. Third Party Liability Insurance

As an Athlete/Owner you are personally responsible for damages to third parties caused by you, your employees, Support Personnel, your agents or your Horses. You are, therefore,

strongly advised to take out third-party liability insurance providing full coverage in relation to FEI Events at home and abroad, and to keep the policy up to date.

The FEI and the Organiser will NOT be responsible for any damage caused to third parties by you, your employees, Support Personnel, your agents or your Horses.

2.2.2. Additional Liability Information

Space for organiser to include reference to National Laws when necessary

2.2.3. Horse Insurance

As an Owner you should ensure that your Horses are adequately insured against any injuries or illnesses they may sustain while participating at a FEI Event.

Space for organiser to include reference to National Laws when necessary

3. PROTESTS/APPEALS

To be valid, all Protests and Appeals must be made in writing and accompanied by a deposit of CHF 150.- or equivalent.

Protest and appeal forms are available on the FEI website:

Protests: <http://inside.fei.org/sites/default/files/FEI%20Protest%20Form.pdf>

Appeals: <http://inside.fei.org/sites/default/files/FEI%20Appeal%20Form.pdf>

4. SCHOOLING DURING COMPETITIONS

Athletes wishing to school during speed competitions (Table A and Table C) must inform the OC before these competitions begin. These athletes will start first in these competitions.

5. STEWARDING

- If an athlete is uncertain as to whether the boots he/she intends to use during an event are allowed, he/she or his/her representative should show the boots to the Chief Steward for his/her opinion before the boots are used in training or in competition.
- In addition, athletes are to be made aware that hind boots must be removed and placed again on the horse's legs in the presence of a Steward while in the warm-up arena prior to entering the competition arena for certain competitions. (If bandages are used in place of boots, athletes are not required to remove the bandages in the warm-up arena.) This procedure is compulsory for competitions for which boot and bandage control is mandatory, that is the Nations Cup, Grand Prix, and the competition with the highest prize money, and is at the discretion of the Chief Steward for other competitions.
- As an alternative to carrying out this procedure at the time designated by the Steward an athlete may ask his/her groom to take the boots to the in-gate and place them on the horse's legs in front of the Steward prior to the combination entering the arena.

- The Steward has the authority to intervene if a boot is deemed excessively tight by instructing that the boot be removed and put on again correctly. *[Stewards are to note that it is normal for a horse's gait to be somewhat affected immediately after boots have been removed and re-placed.]* If an athlete or his/her groom refuses to remove and re-place the boot(s) when instructed to do so by the Steward, a Yellow Warning Card will be issued to the athlete in question.
- If it is deemed impossible or unsafe to remove the hind boots in the warm-up arena prior to the combination entering the competition arena, due to an extremely excited or nervous horse, the boots of the horse in question are to be removed by the athlete/groom following the athlete's round upon leaving the arena and inspected by the Steward. This inspection may be carried out during the boot and bandage control if the boot and bandage control is carried out for the competition in question.
- This procedure does not replace boot and bandage control after completion of an athlete's round for competitions for which boot and bandage control is mandatory (refer to JRs Art. 244.1).

6. DISPUTES

In the event of any discussion concerning the interpretation of the schedule (in translated languages), the English version will be decisive.

7. MODIFICATION TO SCHEDULE

In exceptional circumstances, together with the approval of Chefs d'Equipe, host NF delegate, if any, and the Ground Jury, the Organiser may change the schedule in order to clarify any matter arising from an omission or due to unforeseen circumstances. Any such changes must be notified to all athletes and officials as soon as possible and they must be reported to the FEI Secretary General by the Technical Delegate, the President of the Ground Jury or the Foreign Judge, as applicable.

8. ADDITIONAL INFORMATION FROM THE OC

| |
|---|
| Space for organiser to include any additional information |
|---|

FEI APPROVED SCHEDULE

CSIO5* Sopot (POL) 17-20 June 2021



Age of Athletes and Horses according to the Event's Category

| Event's Category | Age of Athletes (Refer to JRs 255) | Age of Horses |
|---|---|---|
| Olympic Games/WEG | As of 18 th year | Min 9 y.o. |
| Continental Championships Senior | As of 18 th year | Min 8 y.o. |
| Regional Championships/Games | As of 18 th year As of 16 th year if height of obstacles max. 1.40m (JRs Annex IX, Art. 6.1) | Min. 8 y.o. Min. 7 y.o. if height of obstacles max. 1.40m (JRs Art. 254.1.1) |
| World Cup Final | As of 18 th year | Min. 9 y.o. |
| Nations Cup Final | As of 18 th year | Min. 8 y.o. |
| CSI-W3*-5*/CSIO3*-5*/CSI3*-5* Grand Prix, World Cup, Nations Cup, Power and Skill, Derby or Competition with the highest prize money Other Competitions Other Competitions if height max. 1.40m Other Competitions if height max. 1.30m | As of 18 th year As of 16 th year As of 14 th year As of 12 th year | Min. 7 y.o. |
| CSIO1*-2*/CSIO-W1*-2* Grand Prix, World Cup, Nations Cup, Power and Skill, Derby or Competition with the highest prize money Other Competitions Other Competitions if height max. 1.40m Other Competitions if height max. 1.30m | As of 18 th year As of 16 th year As of 14 th year As of 12 th year | Min. 6 y.o. * |
| CSI-W2*/CSI2* World Cup, Power and Skill, Derby Grand Prix, if not the World Cup Competition, and other Competitions Grand Prix, if not the World Cup Competition, and other Competitions if height max. 1.40m Grand Prix, if not the World Cup Competition, and other Competitions if height max. 1.30m | As of 18 th year As of 16 th year As of 14 th year As of 12 th year | Min. 6 y.o. |
| CSI-W1*/CSI1* World Cup, Power and Skill, Derby Grand Prix, if not the World Cup Competition, and other Competitions Grand Prix, if not the World Cup Competition, and other Competitions if height max. 1.30m | As of 18 th year As of 14 th year As of 12 th year | Min. 6 y.o. |
| CH-Y | As of 16 th year to end 21 st year | Min. 7 y.o. |
| CSI/CSIO-Y | As of 16 th year to end 21 st year | Min. 7 y.o. |
| CH-J | As of 14 th year to end 18 th year | Min. 7 y.o. |
| CSI/CSIO-J | As of 14 th year to end 18 th year | Min. 6 y.o. |
| CSI/CSIO-Ch/CH-Ch | As of 12 th year to end 14 th year | Min. 6 y.o. |
| CSI/CSIO-P/CH-P | As of 12 th year to end 16 th year Ponies must be registered as ponies with FEI | Min. 6 y.o. |
| CSIU-25 | As of 16 th year to end 25 th year for all CSIU-25 comp. As of 14 th year if height max. 1.40m (to end 25 th year) | Min. 7 y.o. |
| CSIV | As of 45 th year | Min. 6 y.o. |
| CSIAm | As of 12 th year until end of 13 th year if competition height is max. 1.30 m; as of 14 th year if height exceeds 1.30 m. | Min. 6 y.o. |
| CSIYH | Per Art. 255.2 | Min. 5 y.o. – Max. 8 y.o. |
| CH-M-YH-S | As of 18 th year or 16 year for athletes qualified with the same horse | 5 y.o. / 6 y.o. / 7 y.o. |

* Art. 254.1.1: Horses entered for CSIO2* Events at which the Nations Cup is built to the dimensions set forth in JRs Art. 264.3 for 2* Events must be at least 6 years old; Horses entered for CSIO2* Events at which the Nations Cup is built to the dimensions set forth in JRs Art. 264.3 for 3* Events or higher must be at least 7 years old.

DEDUCTIONS FROM PRIZE MONEY AT COMPETITIONS:

Full details of any deductions from prize money must be outlined in the schedule. This includes government taxes. If it is necessary for Organisers to deduct such taxes, they must provide participants with an official form indicating the amount of tax deducted.

The tax form must be provided to the athletes upon arrival and returned to the Organiser prior to departing.

ATTENTION: All prizes above 2000 PLN are subject to Polish income tax – 10 %. The amount of prize money for one Athlete above 3.000 PLN will be transferred into the account of the riders up to 7 days after the last day of the show. We will ask all the riders during check in at the show office at the day of arrival, to fill in the document with their bank account details (Name of the Bank, Account Holder, Account Number, Iban Number, Swift Code). Please make sure that you have all the bank account details with you and you fill in everything correctly! If the document will not be completed correctly it will be impossible to transfer the money!

IMPORTANT

The total amount of prize money shown for each Competition in the schedule must be distributed. (FEI General Regulations articles 127 and 128)

For details of the prize money breakdown for each competition please refer to the tables at the end of this document; the Organiser must specify which of the two (2) tables will be used. The total prize money for the Competition must be distributed among the first twelve (12) placed athletes.

The Organiser must provide additional created prizes for athletes placed beyond twelfth (12th) place. The minimum amount for each of these additional prizes, for athletes placed from thirteenth (13th) to last place, must be clearly specified in the approved schedule and not exceed the prize money of the athlete placed twelfth (12th)

10. MAXIMUM NUMBER OF STARTERS PER COMPETITION

***Annex VI FEI Jumping Rules:**

Maximum 100 starters per Competition other than the GP. If more than 100 starters are declared, the OC must provide the following percentages of additional prize money for every ten declared starters, up to 120 declared starters:

- 101 to 110 declared starters: the OC must provide 133% of the original Competition prize money, which is to be distributed among the 16 best placed athletes in the Competition according to the prize money distribution chart I or II. The additional prize money provided by the OC is not taken into consideration with regard to the overall prize money that determines the star level of the Event or the Longines Ranking point group of the Competition, if applicable.
- 111 to 120 declared starters: the OC must provide 166% of the original Competition prize money, which is to be distributed among the 20 best placed athletes in the Competition according to the prize money distribution chart I or II. The additional prize money provided by the OC is not taken into consideration with regard to the overall prize money that determines the star level of the Event or the Longines Ranking point group of the Competition, if applicable.

If more than 120 starters are declared, the OC must split the Competition into two groups and provide 200% of the original Competition prize money which is to be divided equally between the

two groups. The additional prize money provided by the OC is not taken into consideration with regard to the overall prize money that determines the star level of the Event or the Longines Ranking point group of the Competition, if applicable.

OCs may apply either of the following methods for splitting the Competition:

The competition is split into two groups before it starts. There may be athletes with multiple horses in each group but all horses of any one athlete must be in the same group. If it is not possible to have two groups of equal size there may be a different number of starters in each group;

OR

The competition is run as one single competition and split afterward into two groups and the classification established as follows: the athlete with the best score is the winner of the first group, the athlete with the second best score is the winner of the second group and so on until prizes have been allocated to 25% of the total number of starters. *NB: In this case separate results must be sent to the FEI for each of the two groups, e.g. results for Competition 1a and for Competition 1b.*

In both cases above each group must offer the same amount of prize money. For the avoidance of doubt, it is the number of declared starters in the Competition, not the final number of starters, that determines whether the Competition must be split.

If there are more than 200 declared starters, the OC must split the Competition into three groups and provide the same percentages of additional prize money as indicated above (100% of original Competition prize money to be provided for each of the three groups if each group has 100 or fewer starters; 133% of original prize money to be provided for each group if any of the three groups has 101-110 starters; 166% of original prize money to be provided for each if any of the three groups has 111-120 starters).

³ For CSI-W Events with a Grand Prix Competition in addition to the FEI World Cup™ competitions, the minimum prize money requirements indicated above for the Grand Prix apply only to the FEI World Cup™ Competition as it has the status of a Grand Prix; the Grand Prix Competition at such Events cannot offer more prize money than the prize money offered for the FEI World Cup™ Competition. Refer to the FEI Jumping World Cup™ rules for details relating to date of implementation of this rule at CSI-W Events.

11. GLOSSARY

***Glossary FEI Jumping Rules:**

Fees:

- Compulsory Fee: Compulsory Fees are fees that may be charged by the OC for costs/services not included in the Entry Fee. Compulsory Fees, if charged, must be paid by the Athletes concerned as outlined below. Only the following Compulsory Fees may be charged by the OC, providing full details of the amount to be charged is included in the Schedule and approved by the FEI:
 - NF fee if applicable
 - NF medication control programme fee if applicable
 - FEI EADCMR fee if applicable (OC to indicate in the Schedule if the EADCMR fee is included in the Entry Fee or not)
 - Fee for health/customs-related documents for Horses if these have been requested by the Athlete.
 - Fee for manure disposal (maximum € 40 per horse per Event)
 - Fee for lorry parking if applicable (The fee indicated in the Schedule may only be charged per lorry not per Athlete.)
 - Fee for electric hook-up for lorry (The fee indicated in the Schedule may only be charged per lorry, not per Athlete.)
- Discretionary Fee: Discretionary Fees are fees that may be charged for optional commodities/services that may be purchased by an Athlete if he so chooses and that do not

affect the equity of the Athlete's right to compete at the Event or the well-being of the Horse, such as:

- VIP or premium parking
 - VIP table
 - Extra box for tack or for non-competing Horse
 - Extra bedding and/or fodder (details to be included e.g. shavings, straw, hay)
 - Premium stabling (all stabling at the Event must meet minimum FEI requirements)
- Entry Fee: The Entry Fee is the fee charged to participate in an Event with one Horse and covers the following:
- Stabling of one Horse for the duration of the Event (includes cleaning and disinfecting stables before the event, including between Events that are part of Tours, water and electricity in the stables, first bedding or a fixed amount of bedding depending on the type of event and 24 hour security services for the stables)
 - Use of all facilities at the Event (no infrastructure fees may be charged)
 - Right to participate in all Competitions in accordance with the conditions in the Schedule (no nomination fees or start fees may be charged)
 - Administrative/Office fees (includes all services relating to administration of the Event and running of the Competitions: data/results/timing services, bookkeeping and accreditation services)

XV. ANNEXES

1. FEI ENTRY SYSTEM

Please fill the form below in order to provide you and the other members of your committee or your IT Providers access to the FEI Entry System.

FEI ID¹: 10108040
Name*: KOCZUROWSKA
First Name*: KAJA
E-Mail*: kkoczurowska@sopot.pl
Access Rights*: ☒ Admin² ☐ Consult³
Events⁴:

FEI ID¹:
Name*: WANTKE
First Name*: MARCIN
E-Mail*: marcinwantke@gmail.com
Access Rights*: ☒ Admin² ☐ Consult³
Events⁴:

FEI ID¹: 10148973
Name*: KOCIK
First Name*: ALICJA
E-Mail*: akocik@hipodrom.sopot.pl
Access Rights*: ☒ Admin² ☐ Consult³
Events⁴:

FEI ID¹: 10083948
Name*: KOMOROWSKA
First Name*: AGATA

E-Mail*: agatajarzycka@gmail.com

Access Rights*: ☒ Admin² ☐ Consult³

Events⁴:

¹ If already have an FEI user account.

² Provides you the required access to manage entries and substitutions and download entries/lists.

³ You are just able to consult and download the entries/lists.

⁴ Leave the field blank if the user deals with the entries of all events in the show.

*** Mandatory Fields**

2. RESULTS

In order to proceed with the results publication and for qualification purposes the FEI requires results **to be uploaded directly on the FEI Database** within two days after the conclusion of the event.

All relevant information, file format and tutorial can be found on this page:

<https://inside.fei.org/fei/your-role/it-services/xml-format>

If you or your provider are unable to produce the required files, results will be accepted by e-mail to results@fei.org, in the proper Excel or "XML" format immediately after the event.

Please refer to compulsory format for CSIs/CSIOs/Championships and Games; the file can be downloaded using the following link:

<https://inside.fei.org/fei/your-role/it-services/results/jumping-results-forms>

All results must include FEI Passport Registration number of horses and FEI ID number of Riders.

Please note that as per Art. 109.6 (GR): OCs of International Jumping Events must inform the FEI and NFs whose teams or individuals have taken part, of the results and prize money paid to each placed Athlete and team, within two (2) days following the Event, unless otherwise specified for qualification and ranking reasons as communicated by the FEI. Failure from OCs of International Events to provide the FEI with the appropriate result(s) and/or prize money information by the aforesaid deadline and/or in the aforesaid format shall entail a warning for the first violation and thereafter a fine of CHF 1'000.- per violation.

The FEI may request a copy of the official PDF result signed by the relevant Officials at the Event.

THE APPENDIX (8 PAGES) IS PART OF THIS APPROVED AND SIGNED SCHEDULE AND MUST BE DISTRIBUTED TO ALL OFFICIALS AND NFs AND IS AVAILABLE TO OTHERS UPON REQUEST